

## DMX723WS DMX823WXS DMX80AXS

### MONITOR WITH RECEIVER INSTRUCTION MANUAL

JVCKENWOOD Corporation

- Updated information (the latest Instruction Manual, system updates, new functions, etc.) is available from  
<<https://www.kenwood.com/cs/ce/>>.



# Contents

## **Before Use 4**

Precautions .....	4
How to read this manual .....	5

## **Basic Operations 6**

Functions of the Buttons on the Front Panel ...	6
Turning on the Unit .....	7
Getting Started.....	7
Adjusting the volume .....	9
Touch screen operations .....	9
HOME screen descriptions.....	9
Source selection screen descriptions.....	10
Source control screen descriptions .....	12
Popup menu .....	13
List screen .....	13

## **APPS 14**

Apple CarPlay Operation .....	14
Android Auto™ Operation .....	16
Wireless Mirroring Operation for iPhone .....	17
Wireless Mirroring Operation for Android Smartphone .....	19

## **USB 21**

Connecting a USB device .....	21
USB Basic Operation .....	21
Search Operation.....	23

## **Radio 24**

Radio Basic Operation .....	24
Memory Operation .....	25
Selecting Operation .....	25
Traffic Information .....	26
Radio Setup .....	26

## **Bluetooth Control 27**

Information for using Bluetooth® devices.....	27
Register the Bluetooth device .....	28
Connection Setup .....	28
Playing Bluetooth Audio Device .....	30
Using Hands-Free Unit.....	31
Hands-Free Setup.....	34

## **Other External Components 35**

View Camera .....	35
-------------------	----

## **Setting Up 37**

Monitor Screen Setup .....	37
System Setup .....	37
User Interface Setup.....	38
Special Setup .....	39
Display Setup.....	39
AV Setup .....	41
Connection Setup .....	42

<b>Controlling Audio</b>	<b>44</b>
Speaker/ X'over setup .....	44
Controlling General Audio .....	45
Equalizer Control .....	46
Volume Offset .....	47
Sound Effect .....	47
Listening Position/ DTA .....	48
 <b>Remote control</b>	 <b>49</b>
Functions of the Remote control Buttons .....	49
 <b>Connection/Installation</b>	 <b>51</b>
Before Installation .....	51
Installing the unit .....	53
 <b>Troubleshooting</b>	 <b>58</b>
Problems and Solutions .....	58
Error Messages .....	58
 <b>Appendix</b>	 <b>59</b>
Playable Media and Files.....	59
Specifications.....	60
About this Unit .....	62

# Before Use

## IMPORTANT

- Please read this manual carefully to ensure proper use before using this product. It is especially important that you read and observe **WARNINGS** and **CAUTIONS** in this manual. Please keep the manual in a safe and accessible place for future reference.

## Precautions

### ⚠ WARNINGS

#### ■ To prevent injury or fire, take the following precautions:

- To prevent a short circuit, never put or leave any metallic objects (such as coins or metal tools) inside the unit.
- Do not watch or fix your eyes on the unit's display when you are driving for any extended period.
- If you experience problems during installation, consult your KENWOOD dealer.

#### ■ Precautions on using this unit

- When you purchase optional accessories, check with your KENWOOD dealer to make sure that they work with your model and in your area.
- You can select language to display menus, audio file tags, etc. See **User Interface Setup (P.38)**.
- The Radio Data System or Radio Broadcast Data System feature won't work where the service is not supported by any broadcasting station.

#### ■ Protecting the monitor

- To protect the monitor from damage, do not operate the monitor using a ball point pen or similar tool with the sharp tip.

#### ■ Cleaning the unit

- If the faceplate of this unit is stained, wipe it with a dry soft cloth such as a silicon cloth. If the faceplate is stained badly, wipe the

stain off with a cloth moistened with neutral cleaner, then wipe it again with a clean soft dry cloth.

## NOTE

- Applying spray cleaner directly to the unit may affect its mechanical parts. Wiping the faceplate with a hard cloth or using a volatile liquid such as thinner or alcohol may scratch the surface or erase screened print.

### ■ How To Reset Your Unit

- If the unit or the connected unit fails to operate properly, reset the unit. Press the <Reset> button. The unit returns to factory settings.

#### DMX723WS



#### DMX823WXS



#### DMX80AXS



**NOTE**

- Disconnect the USB device before pressing the <Reset> button. Pressing the <Reset> button with the USB device connected can damage the data stored in the USB device. For how to disconnect the USB device, see Disconnect the USB device **(P.21)**.
- When the unit is turned on after resetting, the Initial SETUP screen appears. See Initial setup **(P.7)**.

**■ Acquiring GPS signal**

The first time you turn on this unit, you must wait while the system acquires satellite signals for the first time. This process could take up to several minutes. Make sure your vehicle is outdoors in an open area away from tall buildings and trees for fastest acquisition. After the system acquires satellites for the first time, it will acquire satellites quickly each time thereafter.

**■ Caution for Smartphone Users**

- Simultaneously running multiple applications on your smartphone while screen sharing places heavy demand on the microprocessor of the phone, potentially affecting communication and performance.
- For best results while pairing with your KENWOOD receiver, please be sure to close any unused applications.

**How to read this manual**

- The screens and panels shown in this manual are examples used to provide clear explanations of the operations.  
For this reason, they may be different from the actual screens or panels used, or some display patterns may be different.
- **Indication language:** English indications are used for the purpose of explanation. You can select the indication language from the **SETUP** menu. See **User Interface Setup (P.38)**.



This symbol on the product means there are important operating and maintenance instructions in this manual.  
Be sure to carefully read instructions in this manual.

# Basic Operations

## Functions of the Buttons on the Front Panel

DMX723WS

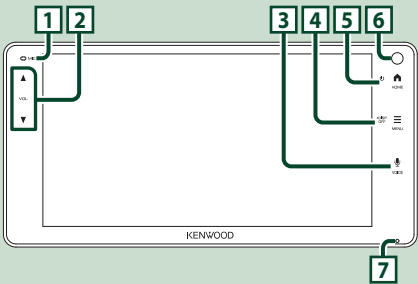

DMX823WXS

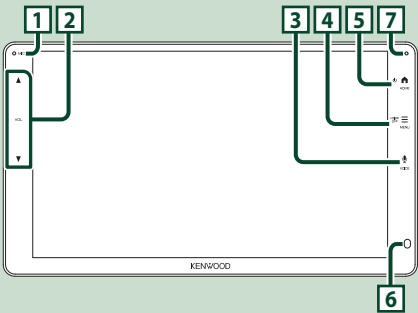

DMX80AXS

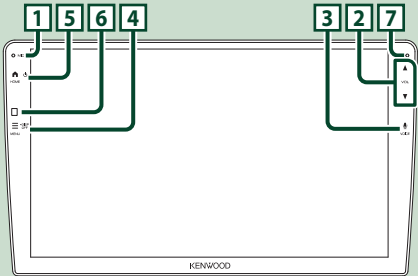

### NOTE

- The panels shown in this guide are examples used to provide clear explanations of the operations. For this reason, they may be different from the actual panels.
- Noise inside the vehicle during a call may affect call quality. If call quality is poor, we recommend setting the air conditioner's fan to the lowest setting.

Name • Motion	
1	Built-in microphone <ul style="list-style-type: none"><li>• Speak via Bluetooth hands-free mode when a Bluetooth telephone is connected.</li></ul>
2	▼, ▲ (VOL) <ul style="list-style-type: none"><li>• Adjusts volume. The volume will go up until 15 when you keep pressing ▲.</li></ul>
3	VOICE <ul style="list-style-type: none"><li>• Displays the Voice Recognition screen (P.32).</li><li>• When neither Apple CarPlay, Android Auto™, nor a Bluetooth Hands-Free phone is connected, pressing and holding displays Bluetooth pairing waiting dialog.</li></ul>
4	MENU <ul style="list-style-type: none"><li>• Displays the popup menu screen.</li><li>• Press and hold to turn off the screen.</li></ul>
5	HOME <ul style="list-style-type: none"><li>• Displays the HOME screen (P.9).</li><li>• Press and hold to turn off the power.</li><li>• When the power off, turns the power on.</li></ul>
6	Remote Sensor <ul style="list-style-type: none"><li>• Receives the remote control signal.</li></ul>
7	Reset <ul style="list-style-type: none"><li>• If the unit or the connected unit fails to operate properly, the unit returns to initial settings when this button is pressed.</li></ul>

## Turning on the Unit

- 1 Press the **HOME** button.

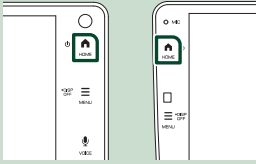

➤ The unit is turned on.

### ● To turn off the unit:

- 1 Press and hold the **HOME** button.

#### NOTE

- If it is your first time turning the unit on after installation, it will be necessary to perform Initial setup (**P.7**).

## Getting Started

### Initial setup

Perform this setup when you use this unit first time.

- 1 Set each item as follows.



#### ■ Language

Select the language used for the control screen and setting items. Default is “**British English(en)**”.

- ① Touch **Language**.
- ② Select the desired language.
- ③ Touch **Close**.

#### ■ Clock

Sets the synchronization of the clock and adjusts it.

For detailed operation, see **Calendar/clock settings (P.8)**.

#### ■ Display (DMX723WS/DMX823WXS only)

Set the key illumination color.

For detailed operation, see **Customizing the key color (P.40)**

#### ■ Camera

Set the parameters for the camera.

- ① Touch **Camera**.
- ② Set each item and touch **↩**.

For detailed operation, see **Camera Setup (P.35)**.

#### ■ DEMO

Set the demonstration mode. Default is “OFF”.

- ① Touch **DEMO** and set **ON** or **OFF**.

**2** Touch **Finish**.



**NOTE**

- These settings can be set from the SETUP menu. See **Setting Up (P.37)**.

## Calendar/clock settings

**1** Press the **MENU** button.

- Popup menu appears.

**2** Touch .



- SETUP Menu screen appears.

**3** Touch **User Interface**.

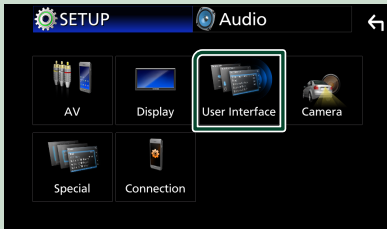

- User Interface screen appears.

**4** Set each item as follows.

Scroll the page to show hidden items.

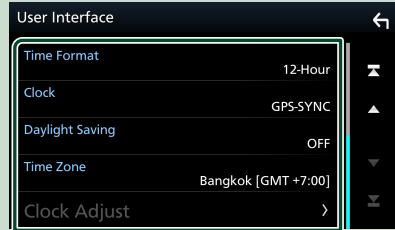

■ **Time Format**

Select the time display format.

**12-Hour** (Default)/ **24-Hour**

■ **Clock**

**GPS-SYNC** (Default): Synchronizes the clock time with the GPS.

**Manual**: Set the clock manually.

■ **Daylight Saving**

(Not used when the clock is set manually)

Activate this by selecting the additional time for daylight saving time (if available in your residential area).

**OFF** (Default)/ **+1 hr. / +30 min.**

■ **Time Zone**

Select the time zone.

■ **Clock Adjust**

If you select **Manual** for Clock, adjust the date and time manually.

**NOTE**

- Please set the date and time. If they are not set, some functions may not work.

## Adjusting the volume

To adjust the volume (0 to 40),  
Press ▲ to increase, and press ▼ to decrease.  
Holding ▲ increases the volume continuously  
to level 15.

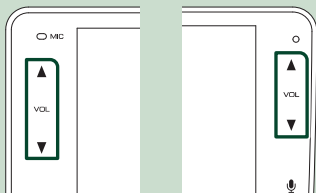

## Touch screen operations

To perform operations on the screen, you need  
to touch, touch and hold, flick or swipe to select  
an item, display setting menu screen or to  
change the page, etc.

### ● Touch

Touch the screen gently to  
select an item on the screen.

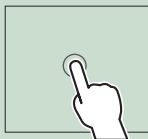

### ● Touch and hold

Touch the screen and keep  
your finger in place until the  
display changes or a message  
is displayed.

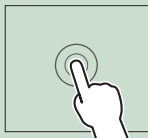

### ● Flick

Slide your finger quickly to  
the left or right on the screen  
to change the page.

You can scroll the list screen  
by flicking the screen up/  
down.

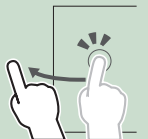

### ● Swipe

Slide your finger up or down  
on the screen to scroll the  
screen.

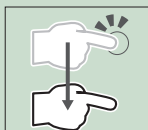

## HOME screen descriptions

Most functions can be performed from the  
HOME screen.



- |   |  |
|---|--|
| 1 | • Displays the control screen of current source. |
| 2 | • Current source information                     |
| 3 | • Displays the source selection screen. (P.10)   |
| 4 | • Short-cut playback source icons (P.11)         |

## Display the HOME screen

### 1 Press the HOME button.

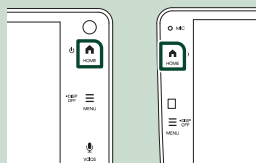

➤ HOME screen appears.

# Source selection screen descriptions



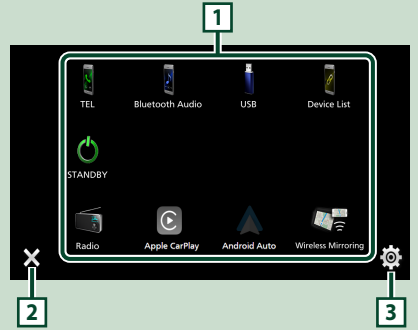





You can display all playback sources and options on the source selection screen.



- |   |  |
|---|--|
| 1 | • Changes the playback source.<br>For playback sources, see <b>Select the playback source (P.10)</b> . |
| 2 | • Returns to previous screen.  |
| 3 | • Displays the SETUP Menu screen. (P.37)   |

## Select the playback source

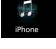
**1** Touch  on the HOME screen.  
From the screen, you can select the following sources and functions.

	• Switches to the Radio broadcast. (P.24)
	• Switches to the Apple CarPlay screen from the connected iPhone. (P.14)
	• Switches to the Android Auto screen from the connected Android smartphone. (P.16)
	• Switches to the Wireless Mirroring screen from the connected iPhone or Android smartphone. (P.17, P.19) It is necessary to connect iPhone or Android smartphone with "MirrorAPP+™" application installed.
	• Displays the Hands Free screen. (P.31) When neither Apple CarPlay, Android Auto, nor a Bluetooth Hands-Free phone is connected, displays "Disconnected" message in the TEL screen. When connecting as Apple CarPlay or Android Auto, it works as a phone provided in Apple CarPlay or Android Auto.
	• Plays a Bluetooth audio player. (P.30)
 	• Plays files on a USB device. (P.21) • Plays an iPhone. If the iPhone is connected via USB when the CarPlay function is set to off on the iPhone side, the USB source will change to the iPhone source. Only some functions of the USB source can be used with the iPhone source.
	• Displays the Device List screen. (P.29)
	• Puts the unit in standby. (P.11)

### To select the playback source on the HOME screen

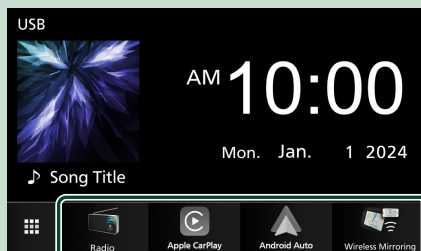

The 4 items displayed on the source selection screen as the large icons are shown on the HOME screen.

You can change items displayed on this area by customizing the source selection screen. **(P.11)**

### Put the unit in standby

**1** Touch  on the HOME screen.

**2** Touch **STANDBY**.

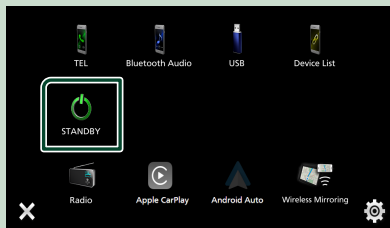

### Customize Short-cut buttons on HOME screen

You can arrange the position of the source icons as you like.

**1** Touch  on the HOME screen.

**2** Touch and hold the icon which you want to move to go into the customizing mode.

**3** Drag it where you want to move.

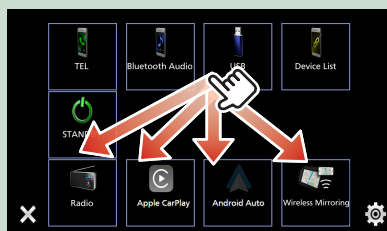

## Source control screen descriptions

There are some functions which can be operated from most screens.

### Indicators

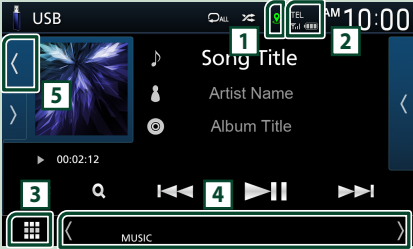

### Sub menu



Displays GPS connection status and reception status.

- : GPS antenna is connected and GPS is being received.
- : GPS antenna is connected, but GPS is not being received.
- : GPS antenna is not connected.

The color of the lower circle indicates the reckoning status. The lower circle blinks red during measurement and turns green when measurement is completed.



Connected Bluetooth device information.

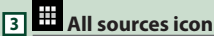

Displays all sources.



- : The Secondary screen changes every time you touch it. You can also change the Secondary screen by flicking left or right on the screen.
- Short-cut source icons: The source changes to the one you have set with a short-cut. For the short-cut setting, refer to **Customize Short-cut buttons on HOME screen (P.11)**.

- Sub menu
  - : Operation when the icon is touched: The first touch darkens the screen, the second, third and forth touch darken the screen further, and the fifth touch restores the screen to its original brightness.
  - : Displays the Graphic Equalizer screen. **(P.46)**
  - : Displays the APP (Apple CarPlay/ Android Auto) screen **(P.14)**.
- Indicators: Displays the current source condition and so on.
  - **MUTE**: The mute function is active.
  - **LOUD**: The loudness control function is on.

### 5 Artwork & information

You can select whether to display an artwork and song information or only song information in more detail.

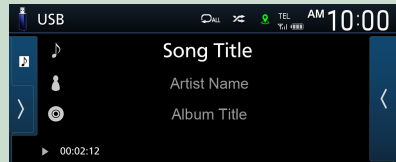
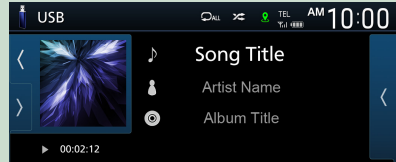

### NOTE

- Depending on the recording language of the file name and song information, the order of characters and scrolling may not be displayed correctly.

## Popup menu

- 1 Press the **MENU** button.

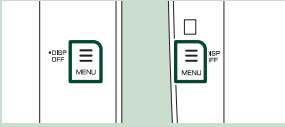

► Popup menu appears.



The contents of the menu are as follows.

	• Displays the Screen Adjustment screen. <b>(P.37)</b>
	• Turns the display off. <b>(P.13)</b>
	• Displays the view camera. <b>(P.35)</b>
	• Displays the SETUP Menu screen. <b>(P.37)</b>
	• Displays the Audio Control Menu screen. <b>(P.44)</b>
	• Displays the Device List screen. <b>(P.29)</b>

## Turn off the screen

- 1 Select on the popup menu.

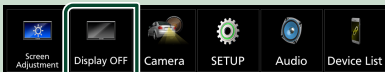

- To turn on the screen

- 1 Touch the display.

## List screen

There are some common function keys in the list screens of most sources.

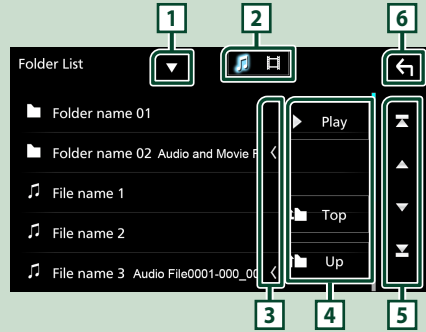

Displays list type selection window.



Displays music/movie file list.



Scrolls the displayed text.



Keys with various functions are displayed here.

- ▶ : Plays all tracks in the folder containing the current track.
- ◀ / : Moves to the upper hierarchy.



You can change the page to display more items by pressing .

- ◀ / : Displays the top or bottom page.



Returns to previous screen.

### NOTE

- Buttons which cannot be activated from the list screen are not displayed.
- Depending on the recording language of the file name and song information, the order of characters and scrolling may not be displayed correctly.

# APPS

## Apple CarPlay Operation

Apple CarPlay is a smarter, safer way to use your iPhone in the car. Apple CarPlay takes the things you want to do with iPhone while driving and displays them on the screen of the product. You can get directions, make calls, send and receive messages, and listen to the music from iPhone while driving. You can also use Siri voice control to make it easier to operate iPhone.

For details about Apple CarPlay, visit <https://www.apple.com/ios/carplay/>.

### NOTE

- If your iPhone isn't working the way you want, try restarting it by turning it off and then turning it back on.

### Compatible iPhone devices

You can use Apple CarPlay with the following iPhone models.

- iPhone 15 Pro Max
- iPhone 15 Pro
- iPhone 15 Plus
- iPhone 15
- iPhone 14 Pro Max
- iPhone 14 Pro
- iPhone 14 Plus
- iPhone 14
- iPhone 13 Pro Max
- iPhone 13 Pro
- iPhone 13
- iPhone 13 mini
- iPhone 12 Pro Max
- iPhone 12 Pro
- iPhone 12
- iPhone 12 mini
- iPhone SE (2nd generation)
- iPhone 11 Pro Max
- iPhone 11 Pro
- iPhone 11
- iPhone XS Max
- iPhone XS
- iPhone XR
- iPhone X
- iPhone 8 Plus
- iPhone 8
- iPhone 7 Plus
- iPhone 7
- iPhone SE
- iPhone 6s Plus
- iPhone 6s

## Preparation

### Wired connection

- 1 Connect your iPhone with the USB cable that matches the connector. (P.57)
- 2 Unlock your iPhone.

### NOTE

- Depending on the iPhone connector, use a genuine Apple Lightning-USB cable or a USB-IF certified USB-C® to USB-A USB cable. If you use non-certified cable, it may not work properly.

### Wireless connection

You can select the iPhone registered in **Device List** and use it as the Apple CarPlay device. See **Register the Bluetooth device (P.28)** and **Switch the connected device (P.29)**.

### NOTE

- Turn on the Bluetooth function and Wi-Fi function of an iPhone.
- If two or more iPhone have been registered, select the iPhone to be used as the **Apple CarPlay** source. See **Switch the connected device (P.29)**.
- It is necessary to connect the GPS antenna in order to use a wireless Apple CarPlay.
- When the Wi-Fi connection becomes unavailable, the HOME screen is displayed.
- You cannot use Apple CarPlay if the function is turned off by operating the iPhone at functional setup.

## Operation buttons and available Apps on the home screen of Apple CarPlay

You can use the Apps of the connected iPhone. The items displayed and the language used on the screen differ among the connected devices.

To enter Apple CarPlay mode, touch **Apple CarPlay** icon in the source selection screen. (P.10)

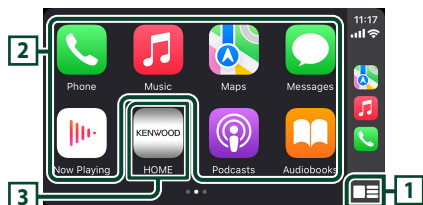

### 1 \*

- Displays the home screen of Apple CarPlay.
- Touch and hold to activates Siri.

### 2 Application buttons

Starts the application.

### 3 HOME

Exits the Apple CarPlay screen and displays the Home screen.

\* The icon design may change depending on the iOS version.

## To exit the Apple CarPlay screen

- 1 Press the **HOME** button.

## Use Siri

You can activate Siri.

- 1 Press the **VOICE** button.



- 2 Talk to Siri.

## Switch to the Apple CarPlay screen while listening to another source

- 1 Press the **HOME** button.

➤ HOME screen appears.

- 2 Touch **Apple CarPlay**.



### NOTE

- When the Apple CarPlay screen is displayed while listening to sound from another source, if you operate an app that produces sound through Apple CarPlay, the source will switch to Apple CarPlay.

## Android Auto™ Operation

Android Auto enables you to use functions of your Android smartphone convenient for driving. You can easily access route guidance, make calls, listen to music, and access convenient functions on the Android smartphone while driving.

For details about Android Auto, visit <https://www.android.com/auto/> and <https://support.google.com/androidauto>.

### NOTE

- If your Android smartphone isn't working the way you want, try restarting it by turning it off and then turning it back on.

### Compatible Android smartphone

You can use Android Auto with Android smartphone of Android version 8.0 or later.

### NOTE

- Android Auto may not be available on all devices and is not available in all countries or regions.
- Compatible Android versions are subject to change without notice.

## Preparation

### Wired connection

- 1 Connect an Android smartphone via USB terminal. (P.57)

To use the hands-free function, connect the Android smartphone via Bluetooth.

- 2 Unlock your Android smartphone.

### Wireless connection

You can select the Android smartphone registered in **Device List** and use it as the Android Auto device. See **Register the Bluetooth device (P.28)** and **Switch the connected device (P.29)**.

### NOTE

- Turn on the Bluetooth function and Wi-Fi function of Android smartphone.
- If two or more Android smartphones have been registered, select the Android smartphone to be used as the Android Auto source. See **Switch the connected device (P.29)**.
- When the Wi-Fi connection becomes unavailable, the HOME screen is displayed.

## Operation buttons and available Apps on the Android Auto screen

You can perform the operations of the Apps of the connected Android smartphone.

The items displayed on the screen differ among the connected Android smartphone.

To enter Android Auto mode, touch **Android Auto** icon in the source selection screen. (P.10)

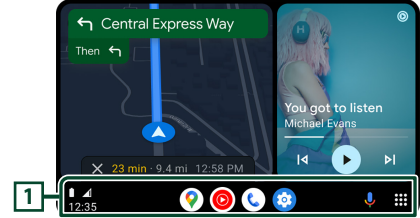

### 1 Application/information buttons

Starts the application or displays information.

### To exit the Android Auto screen

- 1 Press the **HOME** button.

## Using voice control

- 1 Press the **VOICE** button.



- 2 Start speaking.

### To cancel

- 1 Press the **VOICE** button.

## Switch to the Android Auto screen while listening to another source

- 1 Press the **HOME** button.  
➤ HOME screen appears.
- 2 Touch **Android Auto**.



### NOTE

- When the Android Auto screen is displayed while listening to sound from another source, if you operate an app that produces sound through Android Auto, the source will switch to Android Auto.

## Wireless Mirroring Operation for iPhone

You can display and control the App on the unit while your iPhone is connected via Bluetooth.

To use Wireless Mirroring, follow the instructions on your iPhone.

### NOTE

- When using Wireless Mirroring, park in a safe place. While driving, an iPhone screen will not appear on this unit's display.
- Some content and applications may not display or output sound due to copyright reasons.
- If your iPhone isn't working the way you want, try restarting it by turning it off and then turning it back on.

## Preparation



- 1 Download Mirroring App from the App store.

Install the latest version of the Mirroring application "MirrorAPP+" on your iPhone.

### NOTE

- Go to the MirrorAPP+ web page on the App Store to confirm compatibility.
- This application is not provided by JVCKENWOOD.  
JVCKENWOOD is not liable for any damages incurred by the customer in connection with the use of the application, except in cases where such damages are caused by JVCKENWOOD's willful misconduct or gross negligence.

## Connecting an iPhone

- 1 Press the **MENU** button.  
➤ Popup menu appears.
- 2 Touch .  
➤ The Device List screen appears.
- 3 Touch .
- 4 **Launch Mirroring App on your iPhone.**  
Your iPhone will connect to the unit's Wi-Fi.  
Touch **Screen Mirror** to start Mirroring App.  
Touch **Start Broadcast** to start capturing your iPhone screen.  
You can display the same screen of the iPhone on the monitor of the unit.

## 5 Start to enjoy Mirroring.

### NOTE

- When an advertisement appears, touch the **Close** to close it.
- When you lock iPhone screen orientation, please unlock it.

## Mirroring Operation

- 1 Operate your iPhone to activate Mirroring App, then connect to this unit.
- 2 Press the **HOME** button.
- 3 Touch **Wireless Mirroring**.

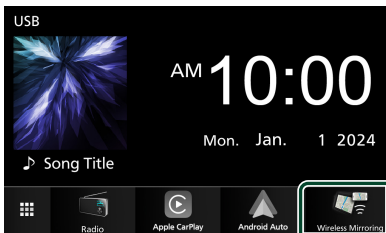

## Operation buttons

- 1 Touch  on the bottom left of the screen.



➤ Operation menu appears.



Displays the iPhone home screen.



Displays the iPhone multitasking screen.



Displays the SETUP Menu screen.

## Wireless Mirroring Operation for Android Smartphone

You can display and control the App on the unit while your Android smartphone is connected via Bluetooth.

To use Wireless Mirroring, follow the instructions on your Android smartphone.

### NOTE

- When using Wireless Mirroring, park in a safe place. While driving, an Android smartphone screen will not appear on this unit's display.
- Some content and applications may not display or output sound due to copyright reasons.
- If your Android smartphone isn't working the way you want, try restarting it by turning it off and then turning it back on.

## Preparation



### 1 Download Mirroring App from the Google Play.

Install the latest version of the Mirroring application "MirrorAPP+" on your Android smartphone.

### NOTE

- Go to the MirrorAPP+ web page on the Google Play to confirm compatibility.
- This application is not provided by JVCKENWOOD. JVCKENWOOD is not liable for any damages incurred by the customer in connection with the use of the application, except in cases where such damages are caused by JVCKENWOOD's willful misconduct or gross negligence.

## Connecting an Android smartphone

- 1 Press the **MENU** button.  
➤ Popup menu appears.
- 2 Touch .  
➤ The Device List screen appears.
- 3 Touch .
- 4 Launch Mirroring App on your Android Smartphone and scan the QR code with the app.  
Your Android smartphone will connect to the unit's Wi-Fi.  
Touch **Start now** to start capturing your Android screen.

### 5 Start to enjoy Mirroring.

### NOTE

- When an advertisement appears, touch the **Close** to close it.

## Mirroring Operation

- 1 Operate your Android smartphone to activate Mirroring App, then connect to this unit.
- 2 Press the **HOME** button.
- 3 Touch **Wireless Mirroring**.

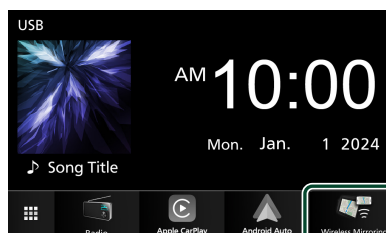

- After the app's advertisement ends, you can display the same screen of the Android smartphone on the monitor of the unit.

## Operation buttons

- 1** Touch  on the bottom left of the screen.

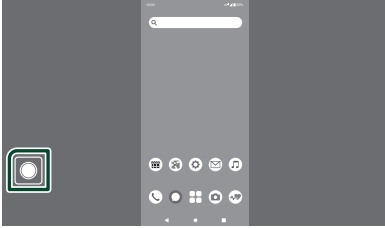

➤ Operation menu appears.



Works the same as the Back button on the Android smartphone.



Works the same as the Home button on the Android smartphone.



Works the same as the App Overview button on the Android smartphone.



Displays the SETUP Menu screen.



Automatically rotates the screen to match the orientation of your smartphone.



Displays the screen in portrait orientation regardless of the orientation of the smartphone.





Displays the screen in landscape orientation regardless of the orientation of the smartphone.

# USB

## Connecting a USB device

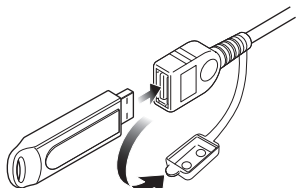
- 1 Connect the USB device with the USB cable. (P.54)



- 2 Press the **HOME** button.
- 3 Touch .
- 4 Touch **USB**. (P.10)

### Disconnect the USB device

- 1 Press the **HOME** button.
- 2 Touch .
- 3 Touch a source other than **USB**.
- 4 Detach the USB device.

### Usable USB device

You can use a mass-storage-class USB device on this unit.

The word “USB device” appearing in this manual indicates a flash memory device.

#### ● About file system

The file system should be the one of the following.

- FAT16    • FAT32    • exFAT    • NTFS

#### NOTE

- Install the USB device in the place where it will not affect safe driving.
- You cannot connect a USB device via a USB hub and Multi Card Reader.
- Take backups of the audio files used with this unit. The files can be erased depending on the operating conditions of the USB device. We shall have no compensation for any damage arising from any erased data.

## USB Basic Operation

Most functions can be controlled from the source control screen and playback screen.

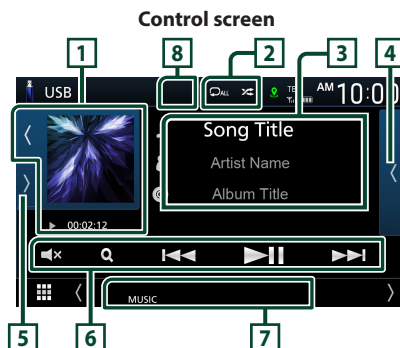



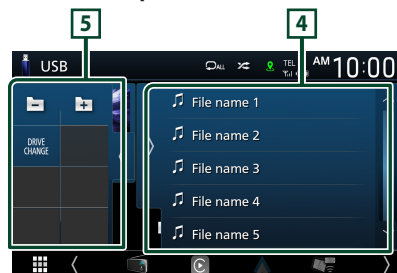



### Open the drawer

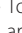
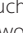







### 1 Artwork/ Play mode indicator/ Playing time

The jacket of the currently playing file is displayed.

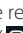
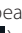
- Touch  /  allows you to hide/display the artwork area.
- , etc.: Current play mode indicator  
The meanings of each icon are as follows;  
 (play),  (fast forward),  (fast backward),  (pause).

### 2 / /

-  : Repeats the current track/folder. Each time you touch the key, repeat mode switches in the following sequence;  
File repeat () , Folder repeat () , Repeat all ()



-  : Randomly plays all tracks in current folder. Each time you touch the key, random mode switches in the following sequence; File random () , Random off ()

### 3 Track information

Displays the information of the current file.

Only a file name and a folder name are displayed if there is no tag information.



### 4 Content list

Touch  on the right side of the screen to display the Content list. Touch  to close the list.





Displays the playing list. When you touch a track/file name on the list, playback will start.

### 5 Function panel

Touch  on the left side of the screen to display the function panel. Touch  to close the panel.

-   : Searches previous/next folder.
- **DRIVE CHANGE** : Switches between partitions in a USB memory that has been fragmented into multiple partitions (up to 2 drives).
- **ASPECT** (Only during video playback): Select screen mode.
  - Full** : Changes the aspect ratio of video and displays fully on the screen.
  - Normal** : Display with 4:3 ratio.
  - Auto** : Displays video fully on vertical or horizontal with no ratio change.

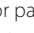
### 6 Operation keys

-  : Searches track/file. For details on search operation, see **Search Operation (P.23)**.
-   : Searches the previous/next track/file.  
Touch and hold to fast forward or fast backward.
-  : Plays or pauses.
-   : Touch to mute or not to mute.

### 7 Indicator Items

- **VIDEO** : Identifies the video file.
- **MUSIC** : Identifies the music file.

### 8 Hide (Video file only)

Touch to hide the operation keys.

### Video screen



### 9 Searching file area (Video file only)

Touch to search the next/previous file.

### 10 Key display area (Video file only)

Touch to display the control screen.

## Search Operation

You can search music or video files by the following operations.

1 Touch **Q**.

2 Touch **▼**.



3 Select the list type.

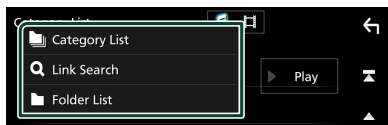

### NOTE

- For operations in the list screen, see **List screen (P.13)**.

## Category search

You can search a file by selecting category.

1 Touch **Category List**.

2 Select whether you search by audio files .

3 Touch the desired category.

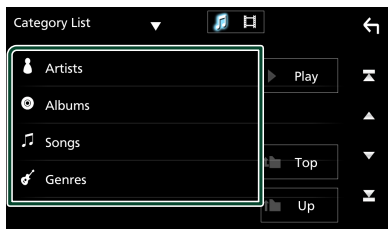

- The list corresponding to your selection appears.

4 Touch to select desired item in the list. Repeat this step until you find the desired file.

## Link search (Audio file only)

You can search a file of same artist/album/genre as the current track.

1 Touch **Link Search**.

2 Touch the desired tag type. You can select from artist, album and genre.

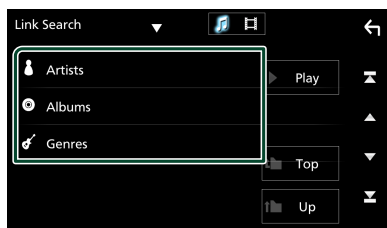

- The list corresponding to your selection appears.



3 Touch desired item from the content list.

## Folder search

You can search a file according to hierarchy.

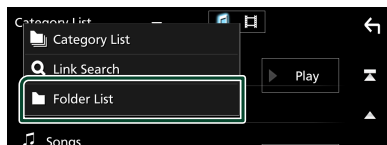
1 Touch **Folder List**.



2 Select whether you search audio files  or video files .

3 Touch the desired folder.

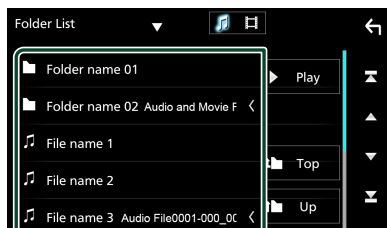

When you touch a folder its contents are displayed.

4 Touch to select desired item in the list. Repeat this step until you find the desired file.

# Radio

## Radio Basic Operation

Most functions can be controlled from the source control screen.

To enter Radio source, touch **Radio** icon in the source selection screen. (**P.10**)

Control screen



Open the drawer



### 1 Information display

Displays the information of the current station: Frequency

Touching allows you to switch between Content A and Content B.

- Content A: PS name, Radio Text, PTY Genre
- Content B: Radio Text plus, Title Artist

**Preset#**: Preset number

### 2 Seek mode

Switches the seek mode in the following sequence; **AUTO1**, **AUTO2**, **MANUAL**.

- **AUTO1**: Tunes in a station with good reception automatically.
- **AUTO2**: Tunes in stations in memory one after another.
- **MANUAL**: Switches to the next frequency manually.

### 3 Operation keys

- : Tunes in a station. The method of frequency switching can be changed (see 2 in table).
- : Touch to mute or not to mute.

### 4 Preset list

- Touch twice on the right side of the screen to display the Preset list. Touch to close the list.
- Recalls the memorized station.
- When touched for 2 seconds, stores the current receiving station in memory.

### 5 Function panel

Touch on the left side of the screen to display the function panel. Touch again to close the panel.

- **TI** (FM only): Sets the traffic information mode on. For details, see **Traffic Information (P.26)**.
- **SETUP** (FM only): Displays the Tuner SETUP screen. For details, see **Radio Setup (P.26)**.
- **PTY** (FM only): Searches a program by setting program type. For details, see **Search by program type (P.25)**.
- **AME**: Presets stations automatically. For details, see **Auto memory (P.25)**.
- **MONO** (FM only): Select the Monaural reception.
- **LO.S** (FM only): Turns the Local Seek function on or off.

### 6 FM AM

Switches the band.

### 7 Indicator Items

- **ST**: A stereo broadcast is being received.
- **MONO**: The forced monaural function is on.
- **TI**: Indicates the reception state of traffic information.
  - White: TP is being received.
  - Orange: TP is not being received.
- **LOS**: The Local Seek function is on.
- **AF**: The AF search function is on.

- **RDS**: Indicates the state of the Radio Data System station when the AF function is on.  
White: Radio Data System is being received.  
Orange: Radio Data System is not being received.
- **EON**: The Radio Data System station is sending EON (Enhanced Other Networks).

## Memory Operation

### Auto memory

You can store stations with good reception in memory automatically.

#### 1 Touch desired band key.

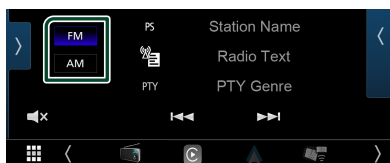

#### 2 Touch **PT** on the left side of the screen. Touch **AME**.



➤ A confirmation screen appears.

#### 3 Touch **Yes**.

➤ Auto memory starts.

### Manual memory

You can store the current receiving station in memory.

- 1 Select a station you wish to store in memory.
- 2 Touch **FM#** (#: 1-24) or **AM#** (#: 1-12) on the preset list in which you want to store the station for 2 seconds.

## Selecting Operation

### Preset select

You can list and select memorized station.

#### 1 Touch **PT** twice on the right side of the screen. Select a station from the list.



### Search by program type (FM only)

You can tune to a station with a specific program type when listening to FM.

#### 1 Touch **PT** on the left side of the screen. Touch **PTY**.

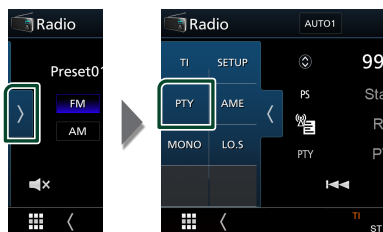

➤ PT Search screen appears.

#### 2 Select a program type from the list.

#### 3 Touch **Search**.

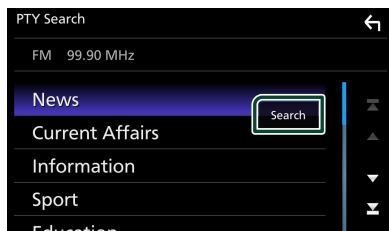

You can search a station of the selected program type.

Traffic Information (FM only)

You can listen and watch the traffic information automatically when a traffic bulletin starts. However, this feature requires a Radio Data System that includes the TI information.

- 1 Touch on the left side of the screen. Touch **TI**.

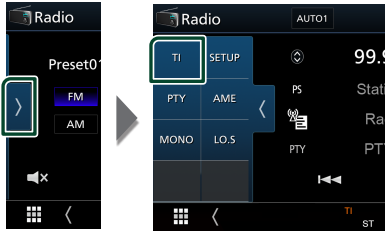

➤ Traffic information mode is set.

When the traffic bulletin starts

The Traffic Information screen appears automatically.

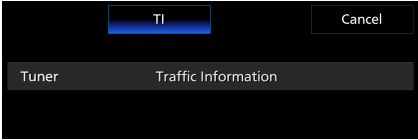

Radio Setup (FM only)

You can set tuner related parameters.

- 1 Touch .
- 2 Touch on the left side of the screen. Touch **SETUP**.



➤ Radio SETUP screen appears.

- 3 Set each item as follows.

**■ AF**  
When station reception is poor, automatically switches to the station that is broadcasting the same program over the same Radio Data System network. Default is "OFF".

**■ Regional**  
Sets whether to switch to the station only in the specific region using the "AF" control.

# Bluetooth Control

Using the Bluetooth function, various functions can be used: listening to the audio file, making/receiving a call.

## Information for using Bluetooth® devices



Bluetooth is a short-range wireless radio communication technology for mobile devices such as mobile phones, portable PCs, and other devices.

Bluetooth devices can be connected without cables and communicate with each other.

### NOTE

- While driving, do not perform complicated operations such as dialing numbers, using the phone book, etc. When you perform these operations, stop your car in a safe place.
- Some Bluetooth devices may not connect to this unit depending on the Bluetooth version of the device.
- This unit may not work for some Bluetooth devices.
- Connecting conditions may vary depending on your environment.
- For some Bluetooth devices, the device is disconnected when the unit is turned off.

## About the cell-phone and Bluetooth audio player

This unit conforms to the following Bluetooth specifications:

Version

Bluetooth Ver. 5.0

Profile

Cell-phone:

HFP (Hands Free Profile)

SPP (Serial Port Profile)

PBAP (Phonebook Access Profile)

Audio player:

A2DP (Advanced Audio Distribution Profile)

AVRCP (Audio/Video Remote Control Profile)

Sound codec

SBC, AAC

### NOTE

- The units supporting the Bluetooth function have been certified for conformity with the Bluetooth Standard following the procedure prescribed by Bluetooth SIG.
- However, it may be impossible for such units to communicate with your cell-phone depending on its type.

## Register the Bluetooth device

It is necessary to register the Bluetooth audio player or cell-phone to this unit before using the Bluetooth function.

You can register up to 7 Bluetooth devices.

### NOTE

- Up to 7 Bluetooth devices can be registered. If an attempt is made to register the 8th Bluetooth device, the Bluetooth device connected on the earliest date will be deleted to register the 8th one.

- 1 Turn on the Bluetooth function on your smartphone/cell-phone.
- 2 Search the unit ("DMX\*\*\*\*\*") from your smartphone/cell-phone.
- 3 Operate your smartphone/cell-phone according to the displayed messages.

- Confirm the request on the smartphone/cell-phone.

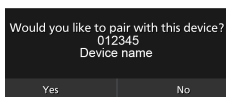

- If a PIN code is required, enter the PIN code ("0000").

- 4 Touch **Yes**.

When data transmission and connection have completed, the Bluetooth connection icon appears on the screen.

### NOTE

- You can also register the Bluetooth device by touching  on the Device List screen.
- The device name selected on step 2 can be changed. See **Change the device name for Bluetooth (P.43)**.

## Connection Setup

- 1 Press the **MENU** button.

➤ Popup menu appears.

- 2 Touch .



➤ SETUP Menu screen appears.

- 3 Touch **Connection**.

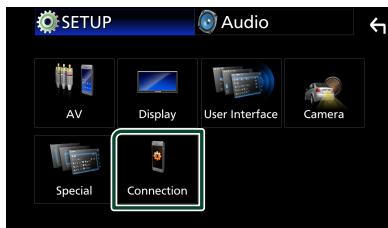

➤ Connection screen appears.

See the following section for each setting.





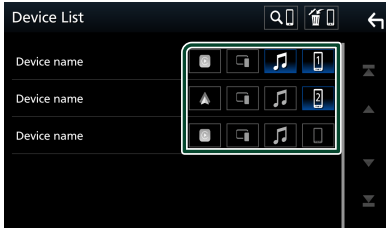

- Switch the connected device (**P.29**)

## Switch the connected device

If two or more Bluetooth devices have been registered, select the device to be used.

- 1 Touch **Device List** on the Connection Setup screen.
- 2 Touch the icon of the device you want to connect.



- The function icon of the connected device will light up.
- Bluetooth Hands-Free phone:  
  - Bluetooth Audio: 
  - Apple CarPlay: 
  - Android Auto: 
  - Wireless Mirroring: 

### NOTE

- Touching a lit function icon will disconnect the device.
- If you touch the Bluetooth phone/Bluetooth audio function icon while connected to Apple CarPlay/Android Auto, a confirmation message for disconnection appears. Touch **Yes** to switch devices.
- Even if the device is compatible with Apple CarPlay or Android Auto, icons are not displayed when;
  - Apple CarPlay is deactivated on the connected device side.
  - The connected device only supports wired Android Auto.
- You can quickly display the Device List screen by touching **Device List** icon on the popup menu screen (P.13).

## To delete the registered Bluetooth device

- 1 Touch  on the Device List screen.

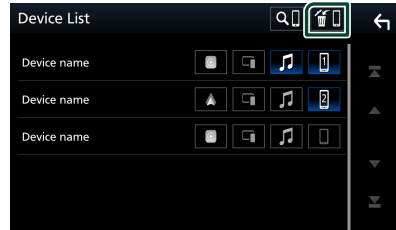

- 2 Touch the device name to delete.

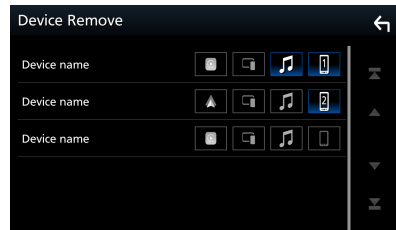

- Confirmation message appears.

- 3 Touch **Yes**.

## Playing Bluetooth Audio Device

Most function can be controlled from the source control screen.

To enter Bluetooth source, touch

**Bluetooth Audio** icon in the source selection screen. (P.10)

### Bluetooth basic operation

Control screen



#### 1 [Repeat] / [Shuffle]

- [Repeat]: Repeats the current track/folder. Each time you touch the key, repeat mode switches in the following sequence; File repeat ([Repeat]), Folder repeat ([Folder]), All songs repeat ([All]), Repeat off ([Off]).
- [Shuffle]: Randomly plays all tracks in current folder. Each time you touch the key, random mode switches in the following sequence; All random ([All]), Random off ([Off]).
- Operations and display indications may differ according to their availability on the connected device.

#### 2 Information display \*

- Displays the name of the track information.
- Connected device name.

#### 3 Operation keys \*

- [Q]: Searches file. See **File search** (P.30).
- [Previous/Next]: Searches the previous/next content. Touch and hold to fast forward or fast backward.
- [Play]: Plays.
- [Pause]: Pauses.
- [Mute]: Touch to mute or not to mute.
- [Device List]: Displays the Device List screen. (P.29)

#### 4 Play mode indicator/ Playing time

- Touch [K] / [J] allows you to hide/display the artwork area.
- [Play], [Pause]: Current play mode indicator  
The meanings of each icon are as follows;  
▶ (play), ▶▶ (fast forward), ◀◀ (fast backward), || (pause).

\* These items appear only when the audio player which supports AVRCP profile is connected.

#### NOTE

- If the operation keys do not appear, operate from the player.
- Depending on your cell-phone or audio player, audio may be heard and controlled but text information may not appear.
- If the volume is too low, raise it on your cell-phone or audio player.

### File search

#### 1 Touch Q.

#### 2 Touch the desired file or folder.



When you touch a folder its contents are displayed.

#### 3 Touch desired item from the content list. ▶ Playback starts.

#### NOTE

- For operations in the list screen, see **List screen** (P.13).

## Using Hands-Free Unit

You can use telephone function by connecting the Bluetooth telephone to this unit.

### NOTE

- While Apple CarPlay or Android Auto is being connected, Bluetooth Hands-Free function cannot be used. Only Apple CarPlay or Android Auto Hands-Free function can be used.

## Make a call

- 1 Touch .









► Hands Free screen appears.

### NOTE

- If your mobile phone supports PBAP, you can display the phone book and call lists on the touch panel screen when the mobile phone is connected.
  - Phone book: up to 1000 entries
  - Up to 20 entries including dialed calls, received calls, and missed calls

- 2 Select a dialing method.



- : Call using call records
- : Call using the phonebook
- : Call using the preset number
- : Call by entering a phone number
- : Voice Recognition (P.32)
- : Device List

### ● Select the device to use

When you connect two devices, touch  to select the phone you want to use.

### ● Device List

- 1) Touch .
- Device List screen appears.

### NOTE

- The status icons such as battery and antenna are displayed for each connected cell-phone. It may differ from those displayed on the cell-phone.
- Setting the cell-phone in the private mode can disable the hands-free function.

## Call using call records

- 1 Touch .
- 2 Select the phone number from the list.

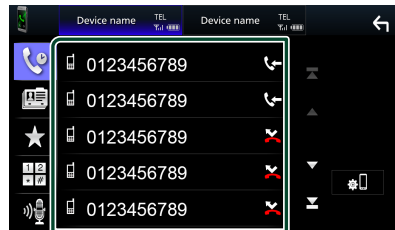

## Call by entering a phone number

- 1 Touch .
- 2 Enter a phone number with number keys.

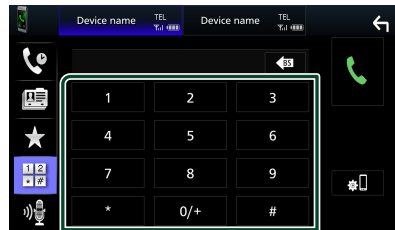

- 3 Touch .

### Call using the preset number

- 1 Touch .
- 2 Touch the Name or phone number.

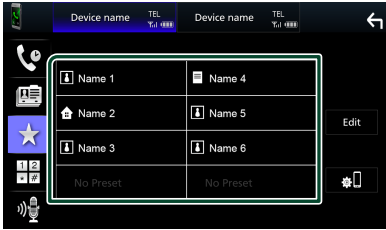

### Call using the phonebook

- 1 Touch .
- 2 Select the person you want to call from the list.

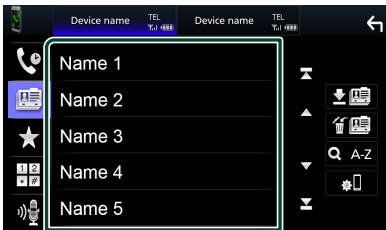

- 3 Select the phone number from the list.

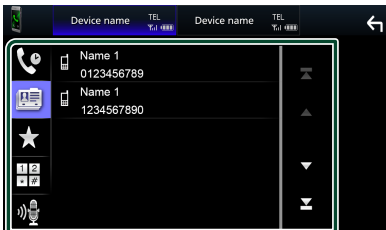

#### NOTE

- If no Phonebook has been downloaded, touching **Download Phonebook Now** will start downloading the Phonebook.

### Voice Recognition

You can access the voice recognition function of the cell-phone connected to this unit. You can search the cell-phone phonebook by voice. (The functionality depends on the cell-phone.)

- 1 Press the **VOICE** button.





➤ Voice Recognition screen appears.

- 2 Start speaking.

#### NOTE

- You can use voice recognition function by touching  on the Hands Free screen.

### Receive a call

- 1 Touch  to answer a phone call or  to reject an incoming call.

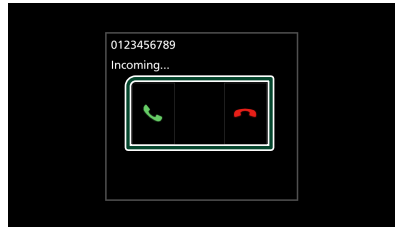

#### NOTE

- While monitoring the view camera, this screen does not appear even if a call comes in. To display this screen, return the shift knob of car to the driver position.

### To end call

- 1 While talking, touch .

## Operations during a call

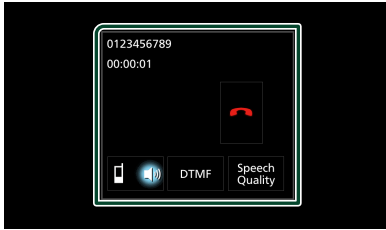

### ● Adjust the volume of your voice

- 1) Touch **Speech Quality**.
- 2) Touch ◀ or ▶ for **Microphone Level**.

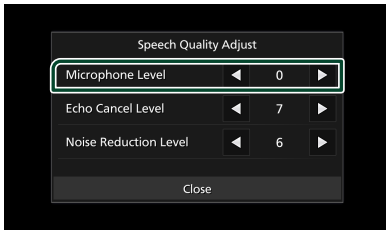

### ● Adjust the receiver volume

Press the ▼ or ▲ button.



### ● Output the dial tone

Touch **DTMF** to display the tone input screen. You can send tones by touching desired keys on the screen.

### ● Switching the speaking voice output

Touching / each time switches the speaking voice output between cell-phone and speaker.

### ● Call-waiting

When you receive a call while talking on another call, you can answer the newly received call by touching . The current call is on hold. Each time you touch , the caller will change. When you touch , the current call will end and switch to the call in hold.

### ● When you receive a call from another connected device during a call

Touch to end the current call and answer a new call. Touch to end the new call and continue the current call.

## Phone number preset

You can register frequently used phone numbers to this unit.

### 1 Touch .

### 2 Touch **Edit**.



### 3 Select where to preset.

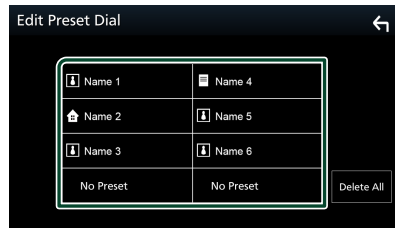

### ■ Delete all

To delete all preset numbers, touch **Delete all** and then touch **Yes** on the confirmation screen.

### 4 Select how to preset.

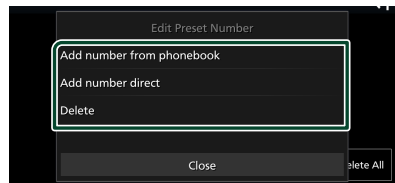

### ■ Add number from phonebook

Select the number to preset from the phonebook. See **Call using the phonebook (P.32)**.

### ■ Add number direct

Enter the telephone number directly and touch **SET**. See **Call by entering a phone number (P.31)**.

### ■ Delete

To delete a preset number, touch **Delete** and then touch **Yes** on the confirmation screen.

## ■ Phonebook transfer

You can transfer the phonebook in your Bluetooth smartphone via PBAP.

1 Touch .

2 Touch .

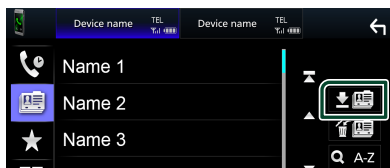

➤ The phonebook data transmission starts.

### NOTE

- The maximum number of phonebook entries that can be transferred to the unit is 1,000. Any phonebook data exceeding this limit cannot be transferred.

## Phonebook deletion

1 Touch .

➤ Confirmation message appears.

2 Touch **Yes**.

## Hands-Free Setup

You can make various settings for the Hands-Free function.

1 Press the **MENU** button.

➤ Popup menu appears.

2 Touch .



➤ SETUP Menu screen appears.

3 Touch **Connection**.



➤ Connection screen appears.

4 Touch **Bluetooth**

➤ Bluetooth screen appears.

5 Touch **TEL SETUP**.

➤ TEL SETUP screen appears.

6 Set each function as follows.

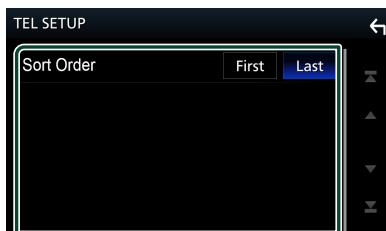

### ■ Sort Order

Set how to sort the data in the smartphone/cell-phone phonebook.

**First**: Sorts data by the first name.

**Last** (Default): Sorts data by the last name.

7 Touch .



# Other External Components

## View Camera

### ⚠ CAUTION

The position of parking guidelines displayed on the monitor may differ from actual condition. Please take the actual parking guidelines as reference and check with eyes.

#### NOTE

- To connect a camera, see **P.54**.
- To use a rear view camera, a REVERSE lead connection is required. (**P.55**)
- The rear view screen is displayed when you shift the gear to the reverse (R) position.

## Display the camera screen

### 1 Press the **MENU** button.

➤ Popup menu appears.

### 2 Touch .



➤ View camera screen appears.

### 3 Adjust each item as follows.

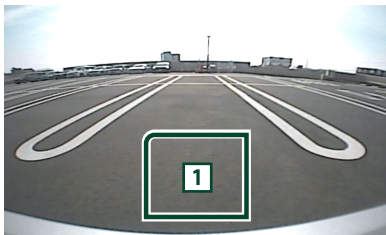

### 1 Camera off

Touch to exit the camera screen.

## Camera Setup

### 1 Press the **MENU** button.

➤ Popup menu appears.

### 2 Touch .

➤ SETUP Menu screen appears.

### 3 Touch **Camera**.

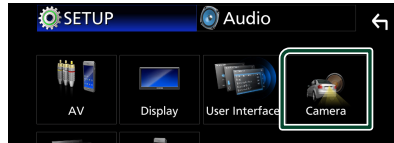

➤ Camera screen appears.

### 4 Set each item as follows.

#### ■ Rear Camera Message

**Always display** (Default): Always displays the caution message on the rear camera interruption screen.

**Clear after 5 seconds**: Displays the caution message for about 5 seconds on the rear camera interruption screen.

#### ■ Parking Guidelines

You can display parking guidelines to enable easier parking when you shift the gear to the reverse (R) position. Default is "ON".

#### ■ Guidelines Setup

If you select **ON** for **Parking Guidelines**, adjust the parking guidelines. See **To adjust the parking guidelines (P.36)**.

### To adjust the parking guidelines

#### NOTE

- Install the rear view camera in the appropriate position according to the instructions supplied with the rear view camera.
- When adjusting the parking guidelines, make sure to use the parking brake to prevent the car from moving.

- 1 Touch **ON** of **Parking Guidelines** in the Camera screen. (P.35)
- 2 Touch **Guidelines SETUP** in the Camera screen.
- 3 Adjust the parking guidelines by selecting the  mark.

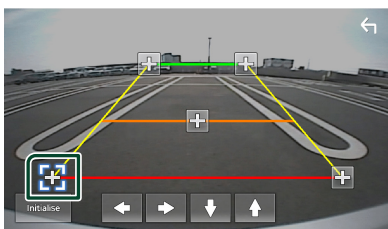

- 4 Adjusting the position of the selected mark.

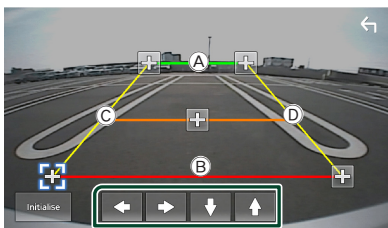

Make sure that (A) and (B) are horizontally parallel, and that (C) and (D) are the same length.

#### NOTE

- Touch **Initialise** and after touch **Yes** to set all the  marks to the initial default position.

# Setting Up

## Monitor Screen Setup

You can adjust image quality in video screen.

### 1 Press the **MENU** button.

➤ Popup menu appears.

### 2 Touch .



➤ Screen Control screen appears.

### 3 Adjust each item as follows.



#### ■ Backlight

#### ■ Contrast

#### ■ Brightness

#### ■ Colour

#### ■ Tint

#### ■ Aspect

Select screen mode.

**Auto** (Default): Displays video fully on vertical or horizontal with no ratio change.

**Full**: Changes the aspect ratio of video and displays fully on the screen.

**Normal**: Display with 4:3 ratio.

## NOTE

- Adjusting items are different depending on the current source.

## System Setup

### 1 Press the **MENU** button.

➤ Popup menu appears.

### 2 Touch .



➤ See the following section for each setting.

- Set up AV ([P.41](#))
- Set up display ([P.39](#))
- Set up the user interface ([P.38](#))
- Set up camera ([P.35](#))
- Set up special ([P.39](#))
- Set up connection ([P.28](#))

## User Interface Setup

You can setup user interface parameters.

### 1 Press the **MENU** button.

➤ Popup menu appears.

### 2 Touch .

➤ SETUP screen appears.

### 3 Touch **User Interface**.



➤ User Interface screen appears.

### 4 Set each item as follows.

#### ■ Beep

Turns the key touch tone on or off.  
Default is "OFF".

#### ■ Language

Selects a language.

#### ■ Steering Remote Controller

Sets the desired function in the steering remote controller. See **Learning function of steering remote (P.38)**.

#### ■ Time Format

Select the time display format.  
"12-Hour" (Default)/ "24-Hour"

#### ■ Clock

#### ■ Daylight Saving

#### ■ Time Zone

#### ■ Clock Adjust

You can set the date and time.

## Learning function of steering remote

This function is available only when your vehicle is equipped with the electrical steering remote controller.

If your steering remote controller is not compliant, learning may not be completed and error message may appear.

### 1 Touch **Steering Remote Controller** in the **User Interface** screen.

➤ Steering Remote Controller screen appears.

### 2 Touch the function you want to set.

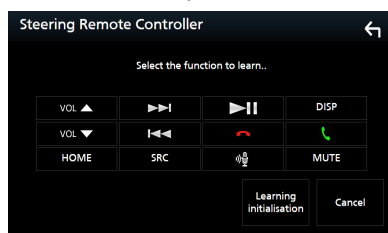

### 3 Press and hold the steering remote controller button.

### 4 Repeat steps 2 and 3 as necessary.

### 5 Touch .

#### NOTE

- When changing the function already learned, select the function from the function list in step 2 and then press and hold the button you want to change.
- Confirm the contents of the settable function on the function list. You cannot edit the function list.

## Special Setup

You can setup Special parameters.

- 1 Press the **MENU** button.  
➤ Popup menu appears.
- 2 Touch .  
➤ SETUP screen appears.
- 3 Touch **Special**.



➤ Special screen appears.

- 4 Set each item as follows.

### ■ DEMO

Set the demonstration mode. Default is "OFF".

### ■ Product Info

Displays the product information.  
Check the serial number of this unit.

### ■ Software Information

Check the software version of this unit.  
(P.39)

### ■ Open Source Licenses

Displays the open source licenses.

### ■ Initialise

Touch **Initialise** and then touch **Yes** to set all the settings to the initial default settings.

## ■ Software Information

Check the software version of this unit.

- 1 Touch **Software Information** in the Special screen.
- 2 Confirm the software version.

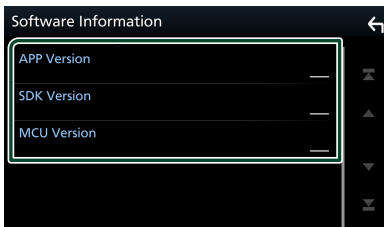

## Display Setup

- 1 Press the **MENU** button.  
➤ Popup menu appears.
- 2 Touch .  
➤ SETUP screen appears.
- 3 Touch **Display**.



➤ Display screen appears.

- 4 Set each item as follows.

### ■ Dimmer

Select dimmer mode.

**OFF**: The display and buttons do not dim.

**ON**: The display and buttons dim.

**SYNC** (Default): Turns the dimmer function on or off when the vehicle light control switch is turned on or off.

### ■ OSD Clock

Select if you want to display the clock while watching video files on USB, etc.

"ON" (Default)/"OFF"

### ■ Key Colour

(DMX723WS/DMX823WXS only)

You can set the key illumination color.

(P.40)

### ■ Wallpaper Customize

Changing wallpaper image. (P.40)

## Setting Up

### ■ Customizing the key color (DMX723WS/DMX823WXS only)

You can set the key illumination color.

- 1 Touch **Key Colour** on the Display screen.
- 2 Touch the desired color.

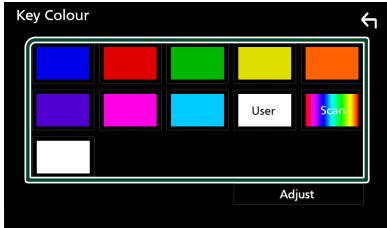

#### ■ User

The color you have set in the process of **Adjust** is registered.

#### ■ Scan

You can set the key color to continuously scan through the color spectrum.

- 3 Touch .

### *To register an original color*

You can register your original color.

- 1 Touch **User** on the key color screen.
- 2 Touch **Adjust**.
- 3 Use **-** and **+** to adjust each color value.



- 4 Touch .

### ■ Change wallpaper image

- 1 Touch **Wallpaper Customize** in the Display screen.
- 2 Select an image.

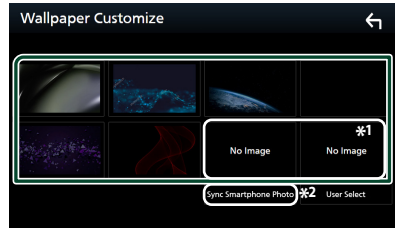

\*1 Select an original image in advance.

\*2 This function is available once MirrorAPP+ is installed on your iPhone or Android smartphone. See the description of the application for details.

## To register original image

You can load an image from the connected USB device and set it for the wallpaper image.

Before operating this procedure, it is necessary to connect the device which has the image to load.

- 1 Touch **User Select** in the wallpaper screen.
- 2 Select the image to load.



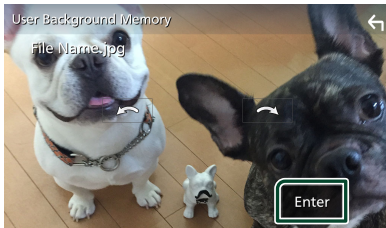

- 3 Touch **Enter**.



- The selected image is loaded and the display returns to the wallpaper screen.

### NOTE

- Touching  rotates counter clockwise.
- Touching  rotates clockwise.
- Picture files: JPEG (.jpg, .jpeg), PNG (.png), BMP (.bmp)
- Maximum number of pixels: 1200 x 1200
- Bit depth: 24 bit

## AV Setup

You can set AV parameters.

- 1 Press the **MENU** button.  
➤ Popup menu appears.
- 2 Touch .
- 3 Touch **AV**.

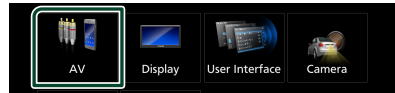

- AV screen appears.

- 4 Set each item as follows.

### ■ AV-OUT

Specify whether to output the current source signal from the VIDEO OUT terminal.

"ON" / "OFF" (Default)

### NOTE

- Images can be output only from the USB (video file) source.

### ■ Driving Position

Select the position of the control bar (left or right) shown on the touch panel.

"Left" / "Right" (Default)

### NOTE

- The setting is available when an iPhone is disconnected.

### ■ Reverse with ATT

When the gear is shifted to the reverse (R) position, the volume of the device is adjusted.

"ON" (Default) / "OFF"

### ■ Guidance Volume

Adjust the level of guidance volume. Default is "15"

### ■ Voice Recognition Volume

Adjust the level of voice recognition volume. Default is "15"

### ■ Phone Incoming Volume

Adjust the level of phone incoming volume. Default is "15"

### ■ Phone Calling/Talking Volume

Adjust the level of phone calling/talking volume. Default is "15"

### ■ Speech Quality Adjust

Adjust the speech quality.

**Microphone Level** : Adjust the level of microphone gain.

**Echo Cancel Level** : Adjust the level of echo cancellation.

**Noise Reduction Level** : Reduce the noise generated in the surrounding environment without changing the microphone volume. Use this function when the voice of caller is not clear.

## Connection Setup

### 1 Press the **MENU** button.

➤ Popup menu appears.

### 2 Touch .

➤ SETUP Menu screen appears.

### 3 Touch **Connection**.



➤ Connection screen appears.

### 4 Touch **Bluetooth**.

➤ Bluetooth screen appears.

### 5 Set each parameter as follows.

#### ■ Bluetooth Device Name

You can change the Bluetooth device name.

See ***Change the device name for Bluetooth (P.43)***.

#### ■ PIN Code

Display the PIN code.

#### ■ Bluetooth MAC Address

Display the MAC address.

#### ■ Auto Response \*

Set the automatic response time to pick-up an incoming call.

**OFF** (Default): Turns off the Automatic response function.

**20/25/30** : Sets the ringing time (second).

#### ■ TEL SETUP

You can change the settings for Hands-Free function. See ***Hands-Free Setup (P.34)***.

\* Either the auto response time set on this unit or the time set on the smartphone/cell-phone, whichever is shorter takes effect.

## Change the device name for Bluetooth

- 1 Touch **Device Name** on the Connection screen.
  - Change Device Name screen appears.
- 2 Touch .
- 3 Input the device name.

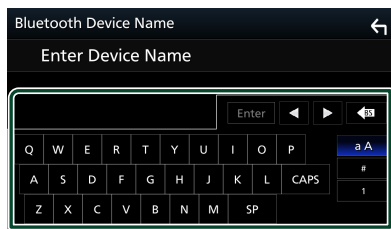

- 4 Touch **Enter**.

# Controlling Audio

You can adjust the various settings such as audio balance or subwoofer level.

## 1 Press the **MENU** button.

➤ Popup menu appears.

## 2 Touch .

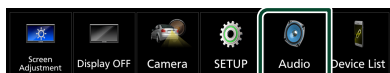

➤ See the following section for each setting.

- Set up speaker/ X'over (**P.44**)
- Controlling equalizer (**P.46**)
- Set listening position/ DTA (**P.48**)
- Controlling general audio (Fader / Balance) (**P.45**)
- Set volume offset (**P.47**)
- Set sound effect (**P.47**)

## Speaker/ X'over setup

## 1 Press the **MENU** button.

➤ Popup menu appears.

## 2 Touch .

➤ Audio screen appears.

## 3 Touch **Speaker/X'over**.



## 4 Select a car type.

You can setup the car type and speaker network, etc.

If your car type is selected, the Delay Time Alignment is set automatically (for timing adjustment of sound output for each channel) to have the highest surround effects.

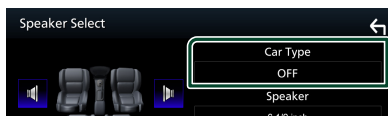

## 5 Touch the speaker (①) you wish to adjust and set each item (②) as follows.



### ■ Speaker

You can select a speaker type and its size to get the best sound effects.

When the speaker type and size are set, the speaker crossover network is set automatically.

### ■ Location (Only for Front, Rear)

Select the speaker position you have fixed.

### ■ Tweeter (Only for Front)

You can set the tweeter when you are selecting front speakers.

**None, Small, Medium, Large**

### ■ X'over

Displays the speaker crossover setup screen.

You can adjust the crossover setup that was set automatically when you selected the speaker type.

For details, see **Crossover network setup (P.45)**

## ■ Crossover network setup

You can set a crossover frequency of speakers.

### 1 Touch X'over.

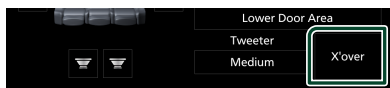

### 2 Touch the speaker to set.



### 3 Set each item as follows.



### ■ HPF FREQ

High Pass Filter adjustment. (When front or rear speaker is selected on Speaker Select screen)

### ■ LPF FREQ

Low Pass Filter adjustment. (When subwoofer is selected on Speaker Select screen)

### ■ Slope \*1

Sets a crossover slope.

### ■ Gain

Adjusts the front speaker, rear speaker, or subwoofer level.

### ■ TW (Tweeter) Gain \*2

Adjusts the tweeter level. (When front is selected on Speaker Select screen)

### ■ Phase Inversion \*3

Sets the phase of subwoofer output.

Check **Phase Inversion** to shift the phase 180 degrees. (When subwoofer is selected on Speaker Select screen)

\*1 Only when "LPF FREQ" / "HPF FREQ" is set to a mode other than "Through" in **X'over**.

\*2 Only when "Tweeter" is set to "Small", "Medium", "Large" in **Speaker Setup**.

\*3 Only when "Subwoofer" is set to a mode other than "None" in **Speaker Setup**.

## Controlling General Audio

### 1 Press the MENU button.

➤ Popup menu appears.

### 2 Touch .

➤ Audio screen appears.

### 3 Touch Fader / Balance.



### 4 Set each item as follows.

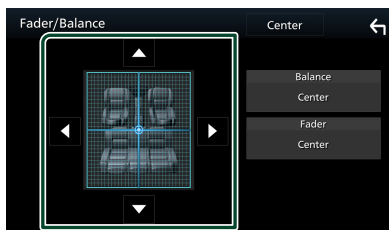

### ■ Fader / Balance

Adjust the volume balance around the touched area.

◀ and ▶ adjust the right and left volume balance.

▲ and ▼ adjust the front and rear volume balance.

### ■ Center

Clear the adjustment.

### Equalizer Control

You can adjust equalizer by selecting the optimized setting for each category.

#### 1 Press the **MENU** button.

➤ Popup menu appears.

#### 2 Touch .

➤ Audio screen appears.

#### 3 Touch **Equaliser**.



#### 4 Touch the screen and set the Graphic Equalizer as desired.

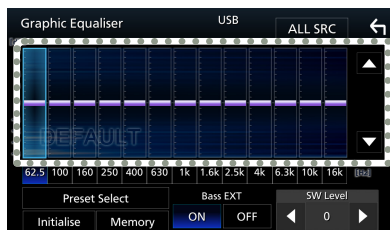

##### ■ **ALL SRC**

Apply the adjusted equalizer to all sources. Touch **ALL SRC** and then touch **OK** on the confirmation screen.

##### ■ **Gain level (dotted frame area)**

Adjust the gain level by touching the each frequency bar.

You can select frequency bar and adjust its level by ▲, ▼.

##### ■ **Preset Select**

Displays the screen to recall the preset equalizer curve.

##### ■ **Initialise**

The current EQ curve returns to flat.

##### ■ **Memory**

Saves the adjusted equalizer curve from "User1" to "User3".

##### ■ **Bass EXT (Bass Extend Settings)**

When turned on, the frequency lower than 62.5 Hz is set to the same gain level as 62.5 Hz.

##### ■ **SW Level**

Adjusts the subwoofer volume.

### Recall the EQ curve

#### 1 Touch **Preset Select**.

#### 2 Select EQ curve.

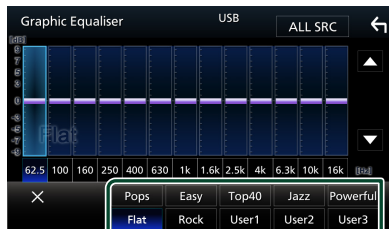

### Save the EQ curve

#### 1 Adjust the EQ curve.

#### 2 Touch **Memory**.

#### 3 Select where to save.

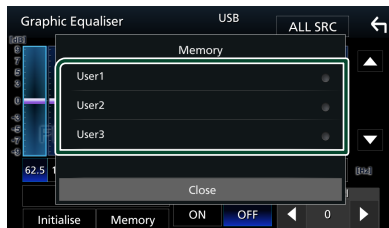

## Volume Offset

Finely adjust the volume of the current source to minimize the difference in volume between different sources.

- 1 Press the **MENU** button.  
➤ Popup menu appears.
- 2 Touch .
- Audio screen appears.
- 3 Touch **Volume Offset**.



- 4 Touch **+** or **-** to adjust the level.

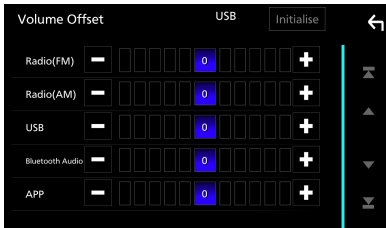

### ■ Initialise

Returns to the initial settings.

\* If you have increased the volume first, then reduced the volume using the “Volume Offset”, the sound generated if you suddenly switch to another source may be extremely loud.

## Sound Effect

You can set sound effects.

- 1 Press the **MENU** button.  
➤ Popup menu appears.
- 2 Touch .
- Audio screen appears.
- 3 Touch **Sound Effect**.



- 4 Set each item as follows.

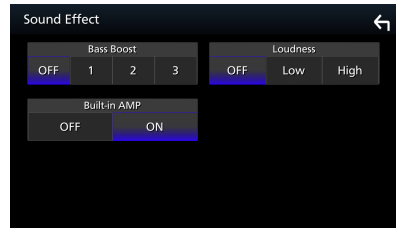

### ■ Bass Boost

Sets the amount of bass boost among “OFF”/“1”/“2”/“3”.

### ■ Loudness

Sets the amounts of boost of low and high tones.

“OFF”, “Low”, “High”

### ■ Built-in AMP

Turn ON/OFF the built-in amplifier.

When an external power amplifier is connected, stopping the current flowing to the built-in amplifier will reduce heat generation and produce better sound.

“OFF”, “ON”

### Listening Position/ DTA

Adjust the sound delay time as nearer speakers to the selected seat have more delay time, so that the sound from each speaker arrive a listener at the same time.

#### 1 Press the **MENU** button.

➤ Popup menu appears.

#### 2 Touch .

➤ Audio screen appears.

#### 3 Touch **Position/DTA**.



#### 4 Select listening position from **Front R** (Right front), **Front L** (Left front), **Front All** (All front), and **All**.

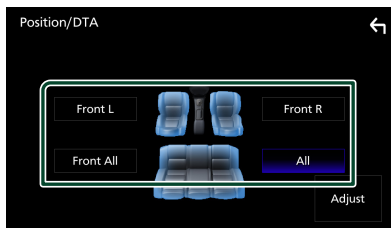

### Position DTA control

You can fine-adjust your listening position.

#### 1 Touch **Adjust**.

#### 2 Touch **Delay**.

#### 3 Touch ◀ or ▶ to adjust the delay time of the selected speaker.

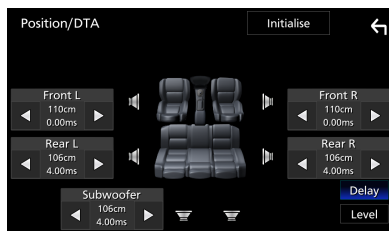

#### 4 Touch **Level**.

#### 5 Touch ◀ or ▶ to adjust the sound level of the selected speaker.



### NOTE

- To return to the initial setting of Delay and Level, touch **Initialise** and **Yes** in the confirmation screen.

# Remote control

This unit can be operated using the remote control KCA-RCDV340 (optional accessory).

## ⚠ CAUTION

- Put the remote control in a place where it will not move during braking or other operations. A dangerous situation could result, if the remote control falls down and gets wedged under the pedals while driving.
- Risk of fire or explosion if the battery is replaced by an incorrect type. Ensure to replace only with the same type.
- Risk of fire, explosion or the leakage of flammable liquid or gas if the battery is left in an extremely high temperature surrounding environment and/or subjected extremely low air pressure. The battery pack or batteries shall not be exposed to excessive heat such as sunshine, fire or the like.
- Risk of fire, explosion or the leakage of flammable liquid or gas if the battery is disposed into fire or a hot oven, recharged, shorted, mechanically crushed or cut of the battery.
- If spilled fluid comes in contact with your eyes or on clothing, immediately rinse with water and consult a physician.

## 🔋 Battery Installation

If the remote control operates only over shorter distances or does not operate at all, it is possible that the batteries are depleted.

In such instances, replace the both batteries with new ones.

- 1 Insert two "AAA"/"R03"-size batteries with the  $\oplus$  and  $\ominus$  poles aligned properly, following the illustration inside the case.

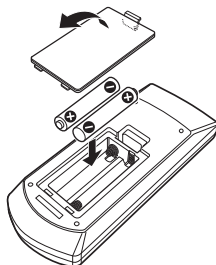

## 📺 Switch the operation mode

Turn its operation mode switch to "AUD."

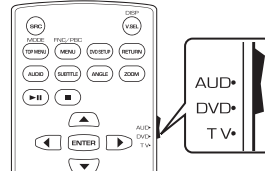

## Functions of the Remote control Buttons

- Aim the remote control directly at the remote sensor on the faceplate.
- DO NOT expose the remote sensor to bright light (direct sunlight or artificial lighting).

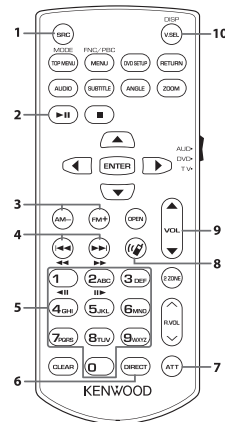

	Key Name	Function
1	SRC	Switches to the source to be played.
2	▶▶	Plays or pauses. For the radio sources, switches the seek mode.
3	FM+ AM-	During radio source, select FM/ AM band to be received.
4	◀◀ ▶▶	Selects the track or file to be played. For the radio source, switches to broadcast stations received by the unit.

	Key Name	Function
5	Numeric Keypad	Allows you to enter the number to search in the direct search mode. For details on the direct search mode, see <b>Direct search mode (P.50)</b> .
6	<b>DIRECT</b>	Switches to the direct search mode. For details on the direct search mode, see <b>Direct search mode (P.50)</b> .
7	<b>ATT</b>	Mutes/restores the sound
8		When a call comes in, answers the call.
9	<b>VOL ▲ ▼</b>	Adjusts the volume.
10	<b>DISP</b>	Switches the screen between the current source and the App screen from the connected iPhone/Android.
–	Other	Not used.

### Direct search mode

Using the remote control, you can jump directly to the tuner frequency.

#### NOTE

- This operation cannot be performed for the USB device.

#### 1 Press the **DIRECT** button.

The available contents are different depending on the source type.

##### Radio

Frequency value

#### 2 Press number buttons to enter a frequency.

#### 3 Press the **◀◀** or **▶▶** button.

- The content corresponding to the number you entered is played.

# Connection/Installation

This section is for the professional installer. For safety's sake, leave wiring and mounting to professionals. Consult the car audio dealer.

## Before Installation

Before installation of this unit, please note the following precautions.

### ▲ WARNINGS

- If you connect the ignition wire (red) and the battery wire (yellow) to the car chassis (ground), you may cause a short circuit, that in turn may start a fire. Always connect those wires to the power source running through the fuse box.
- Do not cut out the fuse from the ignition wire (red) and the battery wire (yellow). The power supply must be connected to the wires via the fuse.
- When wiring wires, be sure to wrap insulating tape, to protect the insulation, around wires where they contact metal parts. Failure to do so may result in fire or electric shock.
- Do not use your own screws. Use only the screws provided. If you use the wrong screws, you could damage the unit.
- If the power is not turned ON ("There is an error in the speaker wiring. Please check the connections." is displayed), the speaker wire may have a short-circuit or touched the chassis of the vehicle and the protection function may have been activated. Therefore, the speaker wire should be checked.
- If your car's ignition does not have an ACC position, connect the ignition wires to a power source that can be turned on and off with the ignition key. If you connect the ignition wire to a power source with a constant voltage supply, such as with battery wires, the battery may be drained.
- If the console has a lid, make sure to install the unit so that the front panel will not hit the lid when closing and opening.
- If the fuse blows, first make sure the wires aren't touching to cause a short circuit, then replace the old fuse with one with the same rating.
- Insulate unconnected wires with vinyl tape or other similar material. To prevent a short circuit, do not remove the caps on the ends of the unconnected wires or the terminals.
- Connect the speaker wires correctly to the terminals to which they correspond. The unit may be damaged or fail to work if you share the ⊖ wires or ground them to any metal part in the car.
- When only two speakers are being connected to the system, connect the connectors either to both the front output terminals or to both the rear output terminals (do not mix front and rear). For example, if you connect the ⊕ connector of the left speaker to a front output terminal, do not connect the ⊖ connector to a rear output terminal.
- After the unit is installed, check whether the brake lamps, blinkers, wipers, etc. on the car are working properly.
- Do not press hard on the panel surface when installing the unit to the vehicle. Otherwise scars, damage, or failure may result.

### ▲ CAUTION

- Install this unit in the console of your vehicle. Do not touch the metal part of this unit during and shortly after the use of the unit. Metal part such as the heat sink and enclosure become hot.
- To prevent injury from sharp edges, etc., do not expose the skin on your arms and hands while installing this unit.
- Be careful not to pinch the harnesses during the installation.

### NOTE

- Mounting and wiring this product requires skills and experience. For best safety, leave the mounting and wiring work to professionals.
- Make sure to ground the unit to a negative 12V DC power supply.
- Do not install the unit in a spot exposed to direct sunlight or excessive heat or humidity. Also avoid places with too much dust or the possibility of water splashing.

## Connection/Installation

- Reception may drop if there are metal objects near the Bluetooth antenna.

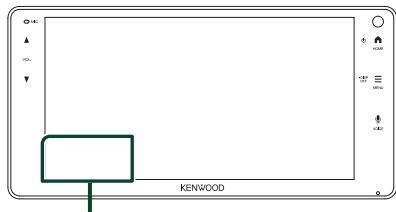

Bluetooth antenna unit

## Supplied accessories for installation

<p>① <sup>[1]</sup></p>	<p>③ <sup>[3]</sup></p>
<p>②</p> <p>(2 m)</p> <p><b>x1</b></p>	<p>③ <sup>[2]</sup></p> <p>(M5 × 8 mm)</p> <p><b>x4</b></p>
<p>④ <sup>[2]</sup></p> <p>(M5 × 8 mm)</p> <p><b>x4</b></p>	<p>⑤ <sup>[4]</sup></p> <p>(φ3 × 10 mm)</p> <p><b>x4</b></p>
<p>⑥</p> <p>(3 m)</p> <p><b>x1</b></p>	<p>⑦</p> <p><b>x1</b></p>
<p>⑧</p> <p><b>x1</b></p>	<p>⑨ <sup>[3]</sup></p> <p><b>x1</b></p>

<sup>[1]</sup> DMX723WS/DMX80AXS only

<sup>[2]</sup> DMX723WS/DMX823WXS only

<sup>[3]</sup> DMX823WXS only

<sup>[4]</sup> DMX80AXS only

## Installation procedure

- 1) To prevent a short circuit, remove the key from the ignition and disconnect the  $\ominus$  terminal of the battery.
- 2) Make the proper input and output wire connections for each unit.
- 3) Connect the speaker wires of the wiring harness.
- 4) Connect the wiring harness wires in the following order; ground, battery, ignition.
- 5) Connect the wiring harness connector to the unit.
- 6) Install the unit in your car.
- 7) Reconnect the  $\ominus$  terminal of the battery.
- 8) Press the reset button.

## Installing the unit

### Japanese cars (DMX723WS/DMX823WXS only)

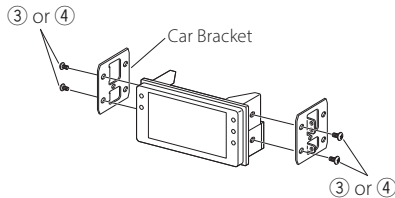

### 1DIN install (DMX723WS/DMX823WXS only)

You can install the unit in a 1DIN size space by removing the right and left brackets.

Remove two black screws from each of the left and right brackets.

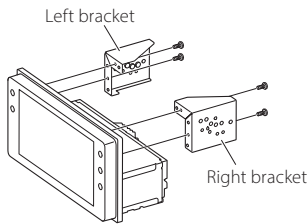

### Cluster panel kit (DMX80AXS only)

- 1) Insert the main unit into the Cluster panel (commercially available) from the front.

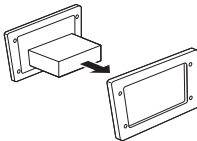

- 2) Secure it from the back with the screws (accessory ⑤).

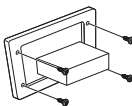

### GPS antenna

GPS antenna is installed inside of the car. It should be installed as horizontally as possible to allow easy reception of the GPS satellite signals.

To mount the GPS antenna inside your vehicle:

- 1) Clean your dashboard or other mounting surface.
- 2) Remove the separator of the metal plate (accessory ⑧).
- 3) Press the metal plate (accessory ⑧) down firmly on your dashboard or other mounting surface. You can bend the metal plate (accessory ⑧) to conform to a curved surface, if necessary.
- 4) Peel off the backing paper of the double-sided tape (accessory ⑦) and use it to attach the GPS antenna (accessory ⑥) and metal plate (accessory ⑧).

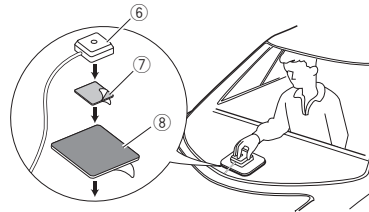

#### NOTE

- Use the supplied GPS antenna. Using the GPS antenna other than the supplied one may cause a drop in positioning accuracy.
- Depending on the type of car, reception of the GPS satellite signals might not be possible with an inside installation.
- Please install this GPS antenna in an area away from any antennas that are used with CB radios or satellite televisions.
- The GPS antenna should be installed at a position that is spaced at least 12 inch (30 cm) from smartphone/cell-phone or other transmitting antennas. Signals from the GPS satellite may be interfered with by these types of communication.
- Painting the GPS antenna with (metallic) paint may cause a drop in performance.

## Connecting wires to terminals

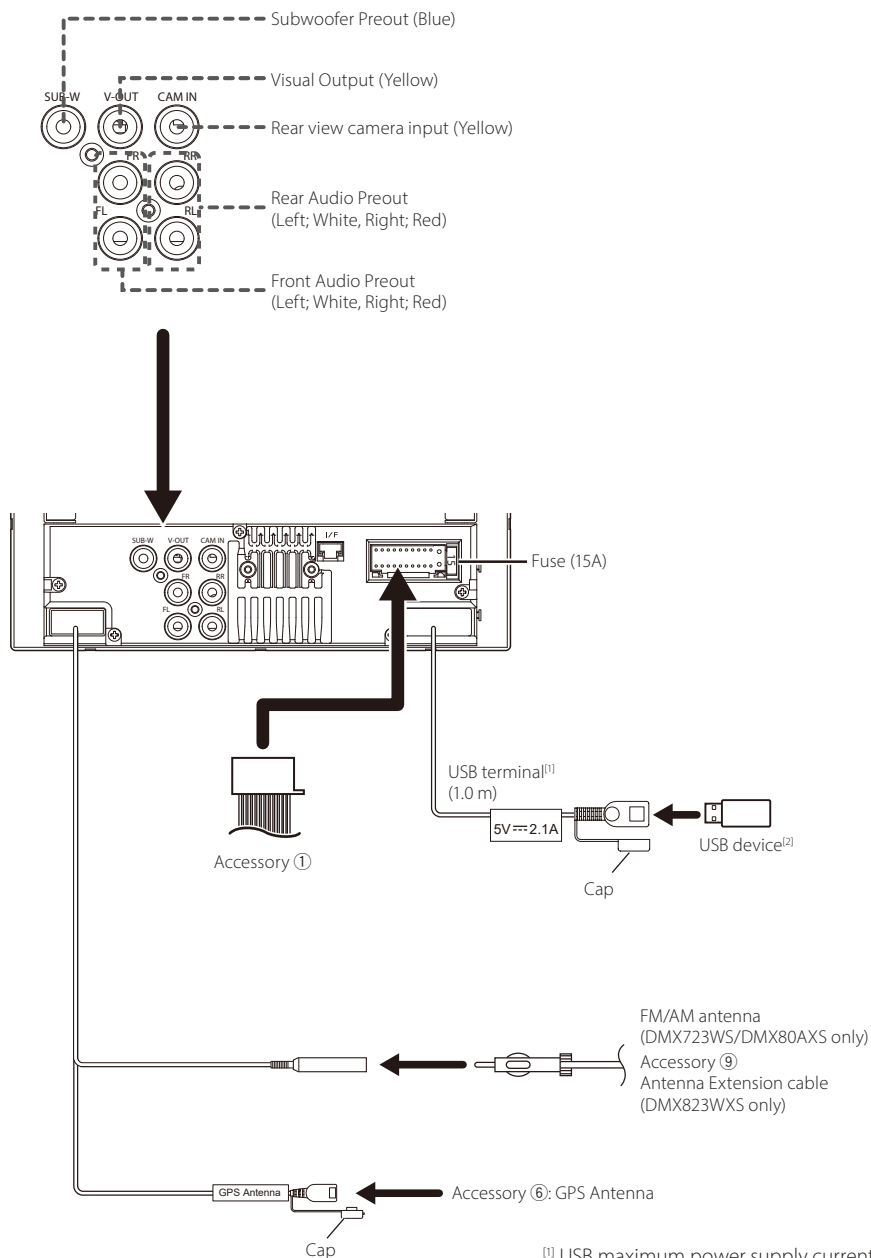

<sup>[1]</sup> USB maximum power supply current :  
DC 5 V 2.1 A

<sup>[2]</sup> Sold separately

DMX723WS/DMX80AXS

Other cable : Not used.

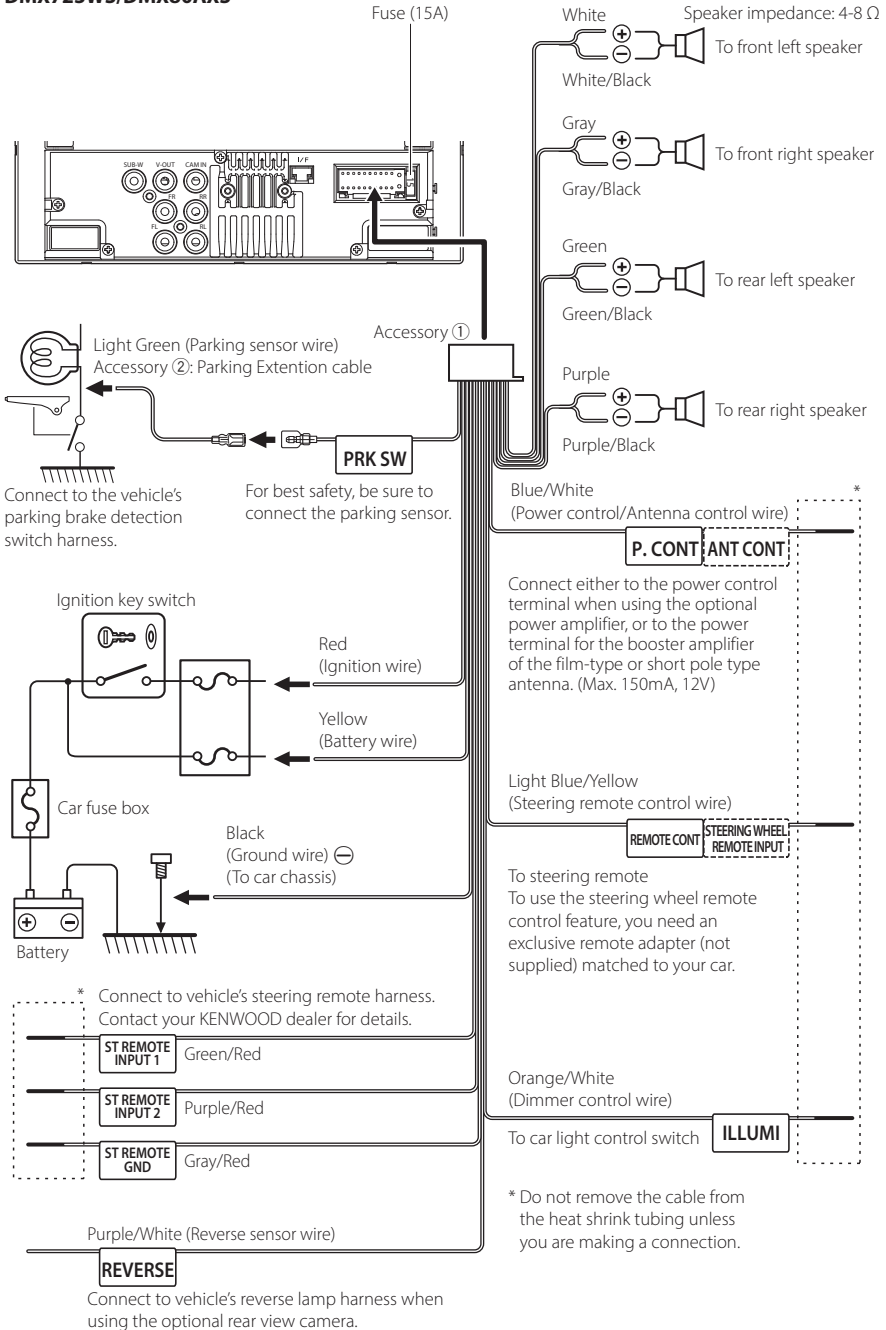

Other cable : Not used.

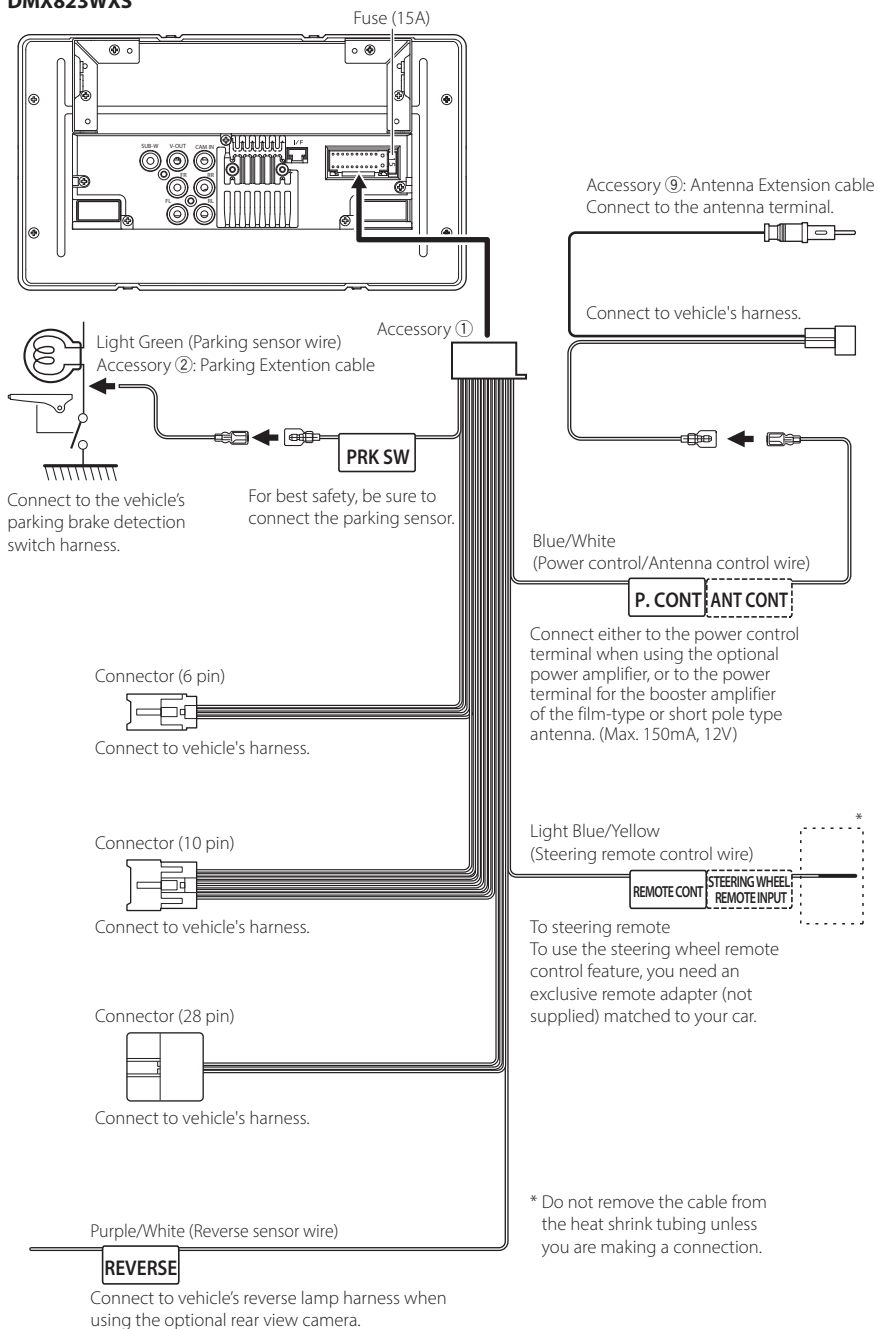
**DMX823WXS**

## Connecting an iPhone/Android

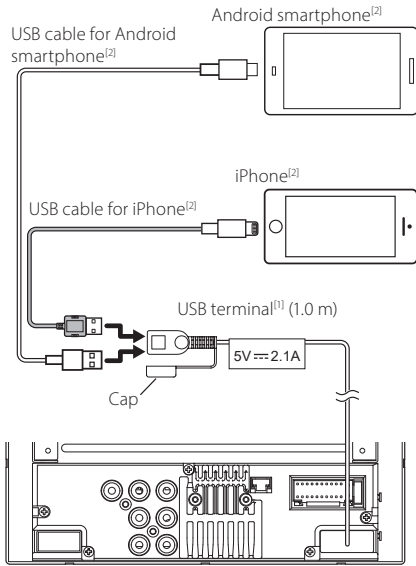

<sup>[1]</sup> USB maximum power supply current :  
DC 5 V  $\approx$  2.1 A

<sup>[2]</sup> Sold separately

# Troubleshooting

## Problems and Solutions

If any trouble occurs, first check the following table for possible problems.

### NOTE

- Some functions of this unit may be disabled by some settings made on this unit.
- What might seem to be a malfunction in your unit may just be the result of slight misoperation or miswiring.

## About settings

- **Cannot set up the subwoofer.**
- **Cannot set up subwoofer phase.**
- **No output from the subwoofer.**
- **Cannot set up the low pass filter.**
- **Cannot set up the high pass filter.**

Subwoofer is not set to on.

- Set the subwoofer to on. See **Speaker/ X'over setup (P.44)**.

## About audio operations

### Radio reception is poor.

The car antenna is not extended.

- Pull out the antenna all the way.

The antenna control wire is not connected.

- Connect the wire correctly. See **Connecting wires to terminals (P.54)**.

### Cannot select a folder.

The random play function is enabled.

- Turn off the random function.

### The sound skips when an audio file is being played.

The recording condition is bad.

- Record the file again or use another USB memory.

## Other

### The Touch Sensor Tone doesn't sound.

The preout jack is being used.

- The Touch Sensor Tone cannot be output from the preout jack.

## Error Messages

When you fail to operate the unit correctly, the cause of the failure appears as the message on the screen.

### No Device (USB device)

The USB device is selected as a source although no USB device is connected.

- Change the source to any source other than USB. Connect a USB device, and change the source to USB again.

### Disconnected (Bluetooth audio player)

The Bluetooth audio player is selected as a source although no Bluetooth audio player is connected.

- Change the source to any source other than Bluetooth. Connect an Bluetooth audio player, and change the source to Bluetooth again.

### No Media file

The connected USB device contains no playable audio file. Media was played that doesn't have data recorded that the unit can play.

- See **Playable Media and Files (P.59)** and try another USB device.

# Appendix

## Playable Media and Files

You can play various kinds of media and files on this unit.

### About files

The following audio and video files are supported.

#### ■ Playable Audio files

	Format	Bit rate	Sampling frequency	Bit count
AAC-LC (.m4a)	MPEG2/4 AAC LC HE-AAC(V1,V2)	8 – 320kbps, VBR	16 – 48 kHz	16 bit
MP3 (.mp3)	MPEG 1/2 Audio Layer 3	8 – 320kbps, VBR	16 – 48 kHz	16 bit
WMA (.wma)	Windows Media Audio Standard L3 profile (Version 7,8,9)	8 – 320kbps	16 – 48 kHz	16 bit
Linear PCM (WAVE) (.wav)	RIFF waveform Audio Format	–	16 – 192 kHz	16/ 24 bit
FLAC (.flac)	flac	–	16 – 192 kHz	16/ 24 bit
Vorbis (.ogg)	vorbis	VBR	16 – 48 kHz	16 bit

#### NOTE

- WMA and AAC of which is covered with DRM cannot be played.
- Although the audio files are complied with the standards listed above, the play may be impossible depending on the types or conditions of media or device.

#### ■ Acceptable Video files

	Profile	Max. Picture size	Max. bit rate	Audio format
MPEG-1 (.mpg, .mpeg)	–	352 × 240, 352 × 288	1.5 Mbps	MPEG Audio Layer 2
MPEG-2 (.mpg, .mpeg)	MP@ML	720 × 480, 720 × 576	8 Mbps	MPEG Audio Layer 2
H.264/MPEG-4 AVC (.mp4, .m4v, .avi, .flv)	Baseline Profile, Main Profile	1920 × 1080 (30 fps)	8 Mbps	MP3, AAC
MPEG-4 (.mp4, .avi)	Advanced Simple Profile	1920 × 1080 (30 fps)	8 Mbps	MP3, AAC
WMV (.wmv)	Main Profile	1920 × 1080 (30 fps)	8 Mbps	WMA
MKV (.mkv)	Video Format follows H.264/MPEG-4 AVC, MPEG-4			MP3, AAC

#### ■ Limitation of structure for the file and the folder

	USB device
Maximum number of folder layers	8
Maximum number of files (per folder)	999
Maximum number of folders (per folder)	9999
Maximum number of folders (per device)	–

#### NOTE

- You can enter a folder name and file name with 255 or fewer single-byte characters.
- Files in the folder whose folder name begins with a dot (.) cannot be played.

## Specifications

### ■ Monitor section

Picture Size

**DMX723WS**

: 6.8 inches (diagonal) wide

**DMX823WXS/DMX80AXS**

: 9 inches (diagonal) wide

Display System

**DMX723WS**

: Transparent TN LCD panel

**DMX823WXS/DMX80AXS**

: Transparent IPS LCD panel

Drive System

: TFT active matrix system

Number of Pixels

: 1,843,200 (1024H × 600V × RGB)

Effective Pixels

: 99.99%

Pixel Arrangement

: RGB striped arrangement

Back Lighting

: LED

### ■ USB interface section

USB Standard

: USB 2.0 High Speed

File System

- USB SW update: FAT32
- USB Playback: FAT16/ 32/ exFAT/ NTFS

Maximum Power Supply Current

: DC 5 V  2.1 A

D/A Converter

: 24 bit

Audio Decoder

: MP3/ WMA/ OGG/ AAC/ WAV/ FLAC

Video Decoder

: MPEG1/ MPEG2/ MPEG4/ WMV/ H.264/ MKV

Frequency Response

- 192 kHz : 20 – 20,000 Hz
- 96 kHz : 20 – 20,000 Hz
- 48 kHz : 20 – 20,000 Hz
- 44.1 kHz : 20 – 20,000 Hz

Total Harmonic Distortion

: 0.2% (1 kHz)

Signal to Noise Ratio

: 75 dB

Dynamic Range

: 93 dB

### ■ Wi-Fi section

Wireless LAN Standards

: IEEE 802.11 a/n/ac

Frequency Range

: 5GHz (5.745 – 5.825GHz)

Channels

: 5GHz: 149ch

Transfer rates (MAX)

: 11a: 54 Mbps / 11n: 150 Mbps / 11ac: 433 Mbps

Output Power

: 5GHz / SISO: 13.78 dBm

### ■ Bluetooth section

Technology

: Bluetooth Ver. 5.0

Frequency

: 2.402 – 2.480 GHz

RF Output Power (E.I.R.P.)

: -1.73 dBm (AVE), Power Class 2

Maximum Communication range

: Line of sight approx. 10 m

Audio Codec

: SBC/ AAC

Profile (Multi Profile support)

- HFP (Hands Free Profile) 1.7
- SPP (Serial Port Profile) 1.2
- A2DP (Advanced Audio Distribution Profile) 1.3
- AVRCP (Audio/Video Remote Control Profile) 1.6
- PBAP (Phonebook Access Profile) 1.2

### ■ DSP section

Graphics equalizer

Band: 13 Band

Frequency (BAND1 – 13)

: 62.5/ 100/ 160/ 250/ 400/ 630/ 1k/ 1.6k/ 2.5k/ 4k/  
6.3k/ 10k/ 16k Hz

Gain

: -9/ -8/ -7/ -6/ -5/ -4/ -3/ -2/ -1/ 0/  
+1/ +2/ +3/ +4/ +5/ +6/ +7/ +8/ +9 dB

2Way X'Over

**High pass filter**

Frequency: Through, 30/ 40/ 50/ 60/ 70/ 80/ 90/  
100/ 120/ 150/ 180/ 220/ 250 Hz

Slope: -6/ -12/ -18/ -24 dB/ Oct.

Gain: -8/ -7/ -6/ -5/ -4/ -3/ -2/ -1/ 0 dB

**Low pass filter**

Frequency: 30/ 40/ 50/ 60/ 70/ 80/ 90/ 100/ 120/  
150/ 180/ 220/ 250 Hz, Through

Slope: -6/ -12/ -18/ -24 dB/ Oct.

Gain: -8/ -7/ -6/ -5/ -4/ -3/ -2/ -1/ 0 dB

**Phase**

: Normal / Reverse

**Position****Front / Rear /Subwoofer Delay**

: 0-6.1m (0.01 m Step)

**Gain**

: -8 – 0 dB

**Subwoofer level**

: -40 – +6 dB

**■ FM tuner section****Frequency Range (step)**

: 87.5 – 108.0MHz (50kHz)

**Usable Sensitivity (S/N: 30 dB)**

: 5 dBμV (5.1 dBμV/75 Ω)

**Frequency Response (± 3.0 dB)**

: 30 Hz – 14 kHz

**S/N (dB)**

: 50 dB (MONO)

**Stereo Separation**

: 35 dB (1 kHz)

**■ AM tuner section****Frequency Range (step)**

: 531 - 1611 kHz (9kHz)

**Usable Sensitivity**

: 99 μV (40 dBμ)

**■ Video section****Color System of External Video Input**

: NTSC/ PAL

**External Video Input Level (RCA jack)**

: 1 Vp-p/ 75 Ω

**Video Output Level (RCA jack)**

: 1 Vp-p/ 75 Ω

**■ Audio section****Maximum Power Output (Front & Rear)**

: 50 W × 4

**Full Bandwidth Power (at less than 1% THD)**

: 22 W × 4

**Output Frequency Band**

: 20 – 20,000 Hz

**Preout Level (V)**

: 2.5 V/ 10 kΩ

**Preout Impedance**

: 1.4 kΩ

**Speaker Impedance**

: 4 – 8 Ω

**■ General****DMX723WS:****Operating Voltage**

: 12V DC Car Battery

**Main Unit Installation size (W × H × D)**

: 205.5 × 104 × 85.7 mm

**Weight**

: 1.07 kg

**DMX823WXS:****Operating Voltage**

: 12V DC Car Battery

**Main Unit Installation size (W × H × D)**

: 235 × 134 × 85.7mm

**Weight**

: 1.34 kg

**DMX80AXS:****Operating Voltage**

: 12V DC Car Battery

**Main Unit Installation size (W × H × D)**

: 229 × 130.5 × 100.8 mm

**Weight**

: 1.33 kg

**NOTE**

- Although the effective pixels for the liquid crystal panel is given as 99.99% or more, 0.01% of pixels may not light or may light incorrectly.

**Specifications subject to change without notice.**

## About this Unit

### ■ Copyrights

- The Bluetooth® word mark and logos are registered trademarks owned by Bluetooth SIG, Inc. and any use of such marks by JVCKENWOOD Corporation is under license. Other trademarks and trade names are those of their respective owners.
- Windows Media is a registered trademark or trademark of Microsoft Corporation in the United States and/or other countries.
- This product is protected by certain intellectual property rights of Microsoft. Use or distribution of such technology outside of this product is prohibited without a license from Microsoft.
- Use of the Made for Apple badge means that an accessory has been designed to connect specifically to the Apple product(s) identified in the badge and has been certified by the developer to meet Apple performance standards. Apple is not responsible for the operation of this device or its compliance with safety and regulatory standards. Please note that the use of this accessory with an Apple product may affect wireless performance.
- Apple, Apple CarPlay, iPhone, Siri and Lightning are trademarks of Apple Inc., registered in the U.S. and other countries and regions.
- App Store is a service mark of Apple Inc., registered in the U.S. and other countries.
- iOS is a trademark or registered trademark of Cisco in the U.S. and other countries and is used under license.
- Google, Android, Google Play, Android Auto and other marks are trademarks of Google LLC.
- To use Android Auto on your car display, you'll need an Android phone running Android 8 or higher, an active data plan, and the Android Auto app.
- USB Type-C® and USB-C® are registered trademarks of USB Implementers Forum.
- MirrorAPP+ is a trademark of Gigaboyz.com Limited.
- Wi-Fi® is a registered trademark of Wi-Fi Alliance®.
- The Wi-Fi CERTIFIED™ Logo is a certification mark of Wi-Fi Alliance®.
- THIS PRODUCT IS LICENSED UNDER THE AVC PATENT PORTFOLIO LICENSE FOR THE PERSONAL USE OF A CONSUMER OR OTHER USES IN WHICH IT DOES NOT RECEIVE REMUNERATION TO (i) ENCODE VIDEO IN COMPLIANCE WITH THE AVC STANDARD ("AVC VIDEO") AND/OR (ii) DECODE AVC VIDEO THAT WAS ENCODED BY A CONSUMER ENGAGED IN A PERSONAL ACTIVITY AND/OR WAS OBTAINED FROM A VIDEO PROVIDER LICENSED TO PROVIDE AVC VIDEO. NO LICENSE IS GRANTED OR SHALL BE IMPLIED FOR ANY OTHER USE. ADDITIONAL INFORMATION MAY BE OBTAINED FROM MPEG LA, L.L.C. SEE [HTTP://WWW.MPEGLA.COM](http://www.mpegla.com)
- THIS PRODUCT IS LICENSED UNDER THE VC-1 PATENT PORTFOLIO LICENSE FOR THE PERSONAL AND NON-COMMERCIAL USE OF A CONSUMER TO (i) ENCODE VIDEO IN COMPLIANCE WITH THE VC-1 STANDARD ("VC-1 VIDEO") AND/OR (ii) DECODE VC-1 VIDEO THAT WAS ENCODED BY A CONSUMER ENGAGED IN A

PERSONAL AND NON-COMMERCIAL ACTIVITY AND/OR WAS OBTAINED FROM A VIDEO PROVIDER LICENSED TO PROVIDE VC-1 VIDEO. NO LICENSE IS GRANTED OR SHALL BE IMPLIED FOR ANY OTHER USE. ADDITIONAL INFORMATION MAY BE OBTAINED FROM MPEG LA, L.L.C. SEE [HTTP://WWW.MPEGLA.COM](http://www.mpegla.com)

- libFLAC  
Copyright (C) 2000,2001,2002,2003,2004,2005,2006,2007,2008,2009 Josh Coalson  
Redistribution and use in source and binary forms, with or without modification, are permitted provided that the following conditions are met:
  - Redistributions of source code must retain the above copyright notice, this list of conditions and the following disclaimer.
  - Redistributions in binary form must reproduce the above copyright notice, this list of conditions and the following disclaimer in the documentation and/or other materials provided with the distribution.
  - Neither the name of the Xiph.org Foundation nor the names of its contributors may be used to endorse or promote products derived from this software without specific prior written permission.

THIS SOFTWARE IS PROVIDED BY THE COPYRIGHT HOLDERS AND CONTRIBUTORS "AS IS" AND ANY EXPRESS OR IMPLIED WARRANTIES, INCLUDING, BUT NOT LIMITED TO, THE IMPLIED WARRANTIES OF MERCHANTABILITY AND FITNESS FOR A PARTICULAR PURPOSE ARE DISCLAIMED. IN NO EVENT SHALL THE FOUNDATION OR CONTRIBUTORS BE LIABLE FOR ANY DIRECT, INDIRECT, INCIDENTAL, SPECIAL, EXEMPLARY, OR CONSEQUENTIAL DAMAGES (INCLUDING, BUT NOT LIMITED TO, PROCUREMENT OF SUBSTITUTE GOODS OR SERVICES; LOSS OF USE, DATA, OR PROFITS; OR BUSINESS INTERRUPTION) HOWEVER CAUSED AND ON ANY THEORY OF LIABILITY, WHETHER IN CONTRACT, STRICT LIABILITY, OR TORT (INCLUDING NEGLIGENCE OR OTHERWISE) ARISING IN ANY WAY OUT OF THE USE OF THIS SOFTWARE, EVEN IF ADVISED OF THE POSSIBILITY OF SUCH DAMAGE.

- libvorbis  
Copyright (c) 2002-2008 Xiph.org Foundation  
Redistribution and use in source and binary forms, with or without modification, are permitted provided that the following conditions are met:
  - Redistributions of source code must retain the above copyright notice, this list of conditions and the following disclaimer.
  - Redistributions in binary form must reproduce the above copyright notice, this list of conditions and the following disclaimer in the documentation and/or other materials provided with the distribution.
  - Neither the name of the Xiph.org Foundation nor the names of its contributors may be used to endorse or promote products derived from this software without specific prior written permission.

THIS SOFTWARE IS PROVIDED BY THE COPYRIGHT HOLDERS AND CONTRIBUTORS "AS IS" AND ANY EXPRESS OR IMPLIED WARRANTIES, INCLUDING, BUT NOT LIMITED TO, THE IMPLIED WARRANTIES OF MERCHANTABILITY AND FITNESS FOR A PARTICULAR PURPOSE ARE DISCLAIMED. IN NO EVENT SHALL THE FOUNDATION OR CONTRIBUTORS BE LIABLE FOR ANY

DIRECT, INDIRECT, INCIDENTAL, SPECIAL, EXEMPLARY, OR CONSEQUENTIAL DAMAGES (INCLUDING, BUT NOT LIMITED TO, PROCUREMENT OF SUBSTITUTE GOODS OR SERVICES; LOSS OF USE, DATA, OR PROFITS; OR BUSINESS INTERRUPTION) HOWEVER CAUSED AND ON ANY THEORY OF LIABILITY, WHETHER IN CONTRACT, STRICT LIABILITY, OR TORT (INCLUDING NEGLIGENCE OR OTHERWISE) ARISING IN ANY WAY OUT OF THE USE OF THIS SOFTWARE, EVEN IF ADVISED OF THE POSSIBILITY OF SUCH DAMAGE.

- libogg

Copyright (c) 2002, Xiph.org Foundation Redistribution and use in source and binary forms, with or without modification, are permitted provided that the following conditions are met:

- Redistributions of source code must retain the above copyright notice, this list of conditions and the following disclaimer.
- Redistributions in binary form must reproduce the above copyright notice, this list of conditions and the following disclaimer in the documentation and/or other materials provided with the distribution.
- Neither the name of the Xiph.org Foundation nor the names of its contributors may be used to endorse or promote products derived from this software without specific prior written permission.

THIS SOFTWARE IS PROVIDED BY THE COPYRIGHT HOLDERS AND CONTRIBUTORS "AS IS" AND ANY EXPRESS OR IMPLIED WARRANTIES, INCLUDING, BUT NOT LIMITED TO, THE IMPLIED WARRANTIES OF MERCHANTABILITY AND FITNESS FOR A PARTICULAR PURPOSE ARE DISCLAIMED. IN NO EVENT SHALL THE FOUNDATION OR CONTRIBUTORS BE LIABLE FOR ANY DIRECT, INDIRECT, INCIDENTAL, SPECIAL, EXEMPLARY, OR CONSEQUENTIAL DAMAGES (INCLUDING, BUT NOT LIMITED TO, PROCUREMENT OF SUBSTITUTE GOODS OR SERVICES; LOSS OF USE, DATA, OR PROFITS; OR BUSINESS INTERRUPTION) HOWEVER CAUSED AND ON ANY THEORY OF LIABILITY, WHETHER IN CONTRACT, STRICT LIABILITY, OR TORT (INCLUDING NEGLIGENCE OR OTHERWISE) ARISING IN ANY WAY OUT OF THE USE OF THIS SOFTWARE, EVEN IF ADVISED OF THE POSSIBILITY OF SUCH DAMAGE.

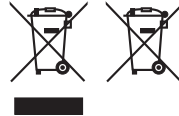

## ■ Information on Disposal of Old Electrical and Electronic Equipment and Batteries (applicable for EU countries that have adopted separate waste collection systems)

Products and batteries with the symbol (crossed-out wheeled bin) cannot be disposed as household waste.

Old electrical and electronic equipment and batteries should be recycled at a facility capable of handling these items and their waste byproducts.

Contact your local authority for details in locating a recycle facility nearest to you.

Proper recycling and waste disposal will help conserve resources whilst preventing detrimental effects on our health and the environment.

## ■ Información acerca de la eliminación de equipos eléctricos, electrónicos y baterías al final de su vida útil (aplicable a los países de la UE que hayan adoptado sistemas independientes de recogida de residuos)

Los productos y las pilas con el símbolo (cubo de basura tachado) no podrán ser desechados como residuos domésticos.

Las pilas y los equipos eléctricos y electrónicos usados se deben reciclar en instalaciones que gestionen tales elementos y residuos.

Póngase en contacto con la autoridad local para obtener detalles acerca de una planta de reciclaje cercana.

Un tratamiento correcto del reciclaje y la eliminación de residuos ayuda a conservar los recursos y evita al mismo tiempo efectos perjudiciales en la salud y el medio ambiente.

## ■ מידע בדבר השלכה לאשפה של ציוד חשמלי ואלקטרוני ישן וכן סוללות (רלוונטי למדינות שמשמשות במערכת איסוף אשפה מופרדת).

לא ניתן להשליך מוצרים וסוללות עם הסימון (פח אשפה X עליו) כאשפה ביתית רגילה.

יש למחזר ציוד חשמלי ואלקטרוני ישן וכן סוללות במתקן המסוגל לטפל בפריטים כאלה ובתוצרי הלוואי שלהם. צרו קשר עם הרשות המקומית לקבלת פרטים אודות מתקן המיחזור הקרוב אליכם. מיחזור והשלכה לאשפה נאותים יעזרו לשמר משאבים ולמנוע השפעות שליליות על בריאותנו ועל הסביבה.



## Declaration of Conformity with regard to the RE Directive 2014/53/EU

## Declaration of Conformity with regard to the RoHS Directive 2011/65/EU

### Manufacturer:

JVCケンウッド Corporation  
3-12, Moriyacho, Kanagawa-ku, Yokohama-shi,  
Kanagawa 221-0022, JAPAN

### EU Representative:

JVCケンウッド Europe B.V.  
Rendementsweg 20 B-9, 3641 SL Mijdrecht, THE  
NETHERLANDS

### English

Hereby, JVCケンWOOD declares that the radio equipment DMX723WS/DMX823WXS/DMX80AXS is in compliance with Directive 2014/53/EU. The full text of the EU declaration of conformity is available at the following internet address:

### Français

Par la présente, JVCケンWOOD déclare que l'équipement radio DMX723WS/DMX823WXS/DMX80AXS est conforme à la directive 2014/53/UE. L'intégralité de la déclaration de conformité UE est disponible à l'adresse Internet suivante :

### Deutsch

Hiermit erklärt JVCケンWOOD, dass das Funkgerät DMX723WS/DMX823WXS/DMX80AXS der Richtlinie 2014/53/EU entspricht. Der volle Text der EU-Konformitätserklärung steht unter der folgenden Internetadresse zur Verfügung:

### Nederlands

Hierbij verklaart JVCケンWOOD dat de radioapparatuur DMX723WS/DMX823WXS/DMX80AXS in overeenstemming is met Richtlijn 2014/53/EU. De volledige tekst van de EU-verklaring van overeenstemming is te vinden op het volgende internetadres:

### Italiano

Con la presente, JVCケンWOOD dichiara che l'apparecchio radio DMX723WS/DMX823WXS/DMX80AXS è conforme alla Direttiva 2014/53/UE. Il testo integrale della dichiarazione di conformità UE è disponibile al seguente indirizzo internet:

### Español

Por la presente, JVCケンWOOD declara que el equipo de radio DMX723WS/DMX823WXS/DMX80AXS cumple la Directiva 2014/53/EU. El texto completo de la declaración de conformidad con la UE está disponible en la siguiente dirección de internet:

### Português

Deste modo, a JVCケンWOOD declara que o equipamento de rádio DMX723WS/DMX823WXS/DMX80AXS está em conformidade com a Diretiva 2014/53/UE. O texto integral da declaração de conformidade da UE está disponível no seguinte endereço de internet:

### Polska

Niniejszym, JVCケンWOOD deklaruje, że sprzęt radiowy DMX723WS/DMX823WXS/DMX80AXS jest zgodny z dyrektywą 2014/53/UE. Pełny tekst deklaracji zgodności EU jest dostępny pod adresem:

### Český

Společnost JVCケンWOOD tímto prohlašuje, že rádiové zařízení DMX723WS/DMX823WXS/DMX80AXS splňuje podmínky směrnice 2014/53/EU. Plný text EU prohlášení o shodě je dostupný na následující internetové adrese:

### Magyar

JVCケンWOOD ezenel kijelenti, hogy a DMX723WS/DMX823WXS/DMX80AXS rádióberendezés megfelel a 2014/53/EU irányelvnek. Az EU konformitási nyilatkozat teljes szövege az alábbi weboldalon érhető el:

### Hrvatski

JVCケンWOOD ovim izjavljuje da je radio oprema DMX723WS/DMX823WXS/DMX80AXS u skladu s Direktivom 2014/53/EU. Cjeloviti tekst deklaracije Europske unije o usklađenosti dostupan je na sljedećoj internet adresi:

### Svenska

Härmed försäkras JVCケンWOOD att radioutrustningen DMX723WS/DMX823WXS/DMX80AXS är i enlighet med direktiv 2014/53 / EU. Den fullständiga texten av EU-försäkran om överensstämmelse finns på följande Internetadress:

### Suomi

JVCケンWOOD julistaa täten, että radiolaitte DMX723WS/DMX823WXS/DMX80AXS on direktiivin 2014/53/EU mukainen. EU-vaatimusten mukaisuusvakuutus löytyy kokonaisuudessaan seuraavasta internet-osoitteesta:

### Slovensko

S tem JVCケンWOOD izjavlja, da je radijska oprema DMX723WS/DMX823WXS/DMX80AXS v skladu z Direktivo 2014/53/EU. Celotno besedilo direktive EU o skladnosti je dostopno na tem spletnem naslovu:

### Slovensky

Spoločnosť JVCケンWOOD týmto vyhlasuje, že rádiové zariadenie DMX723WS/DMX823WXS/DMX80AXS vyhovuje smernici 2014/53/EU. Celý text EU vyhlásenia o zhode nájdete na nasledovnej internetovej adrese:

### Dansk

Herved erklærer JVCケンWOOD, at radioustyret DMX723WS/DMX823WXS/DMX80AXS er i overensstemmelse med Direktiv 2014/53/EU. EU-overensstemmelseserklæringens fulde ordlyd er tilgængelig på følgende internetadresse:

### Norsk

JVCケンWOOD erklærer herved at radioustyret DMX723WS/DMX823WXS/DMX80AXS er i samsvar med Direktiv 2014/53/EU. Den fullstendige teksten til EU-konformitetserklæringen er tilgjengelig på følgende internetadresse:

### Ελληνικά

Με το παρόν, η JVCケンWOOD δηλώνει ότι ο ραδιοεξοπλισμός DMX723WS/DMX823WXS/DMX80AXS συμμορφώνεται με την Οδηγία 2014/53/ΕΕ. Το πλήρες κείμενο της δήλωσης συμμόρφωσης της ΕΕ είναι διαθέσιμο στην ακόλουθη διεύθυνση στο διαδίκτυο:

### Eesti

Käesolevaga JVCケンWOOD kinnitab, et DMX723WS/DMX823WXS/DMX80AXS raadiovarustus on vastavuses direktiiviaga 2014/53/EL. Eli vastavusdeklaratsiooni terviktekst on kättesaadav järgmisel internetiaadressil:

### Latviešu

JVCケンWOOD ar šo deklarē, ka radio aparātūra DMX723WS/DMX823WXS/DMX80AXS atbilst direktīvas 2014/53/ES prasībām. Pilns ES atbilstības deklarācijas teksts ir pieejams šādā tīmekļa adresē:

### Lietuviškai

Šiuo JVCケンWOOD pažymi, kad radijo įranga DMX723WS/DMX823WXS/DMX80AXS atitinka 2014/53/EB direktyvos reikalavimus. Visą EB direktyvos atitikties deklaracijos tekstą galite rasti šiuo internetiniu adresu:

### Malti

B'dan, JVCケンWOOD jiddikjara li t-tagħmir tar-radju DMX723WS/DMX823WXS/DMX80AXS huwa konformi mad-Direttiva 2014/53/EU. It-test kollu tad-dikjarazzjoni ta' konformità huwa disponibbli fl-indirizz intranet li ġej:

**Українська**

Таким чином, компанія JVCKENWOOD заявляє, що радіообладнання DMX723WS/DMX823WXS/DMX80AXS відповідає Директиві 2014/53/EU. Повний текст декларації про відповідність ЄС можна знайти в Інтернеті за такою адресою:

**Türkçe**

Burada, JVCKENWOOD DMX723WS/DMX823WXS/DMX80AXS radyo ekipmanının 2014/53/AB Direktifine uygun olduğunu bildirir. AB uyumluluk deklarasyonunun tam metni aşağıdaki internet adresinde mevcuttur.

**Русский**

JVCKENWOOD настоящим заявляет, что радиооборудование DMX723WS/DMX823WXS/DMX80AXS соответствует Директиве 2014/53/EU. Полный текст декларации соответствия ЕС доступен по следующему адресу в сети Интернет:

**Limba română**

Prin prezenta, JVCKENWOOD declară că echipamentul radio DMX723WS/DMX823WXS/DMX80AXS este în conformitate cu Directiva 2014/53/UE. Textul integral al declarației de conformitate UE este disponibil la următoarea adresă de internet:

**Български език**

С настоящото JVCKENWOOD декларира, че радиооборудването на DMX723WS/DMX823WXS/DMX80AXS е в съответствие с Директива 2014/53/ЕС. Пълният текст на ЕС декларацията за съответствие е достъпен на следния интернет адрес:

**URL :** <https://www.kenwood.com/euukdoc/>

# UK CA

**Declaration of Conformity with regard to the Radio Equipment Regulations 2017 (S.I. 2017/1206)**

**Declaration of Conformity with regard to the Restriction of the Use of Certain Hazardous Substances in Electrical and Electronic Equipment Regulations 2012 (S.I. 2012/3032)**

**Manufacturer:**

JVCKENWOOD Corporation  
3-12, Moriyacho, Kanagawa-ku, Yokohama-shi,  
Kanagawa 221-0022, JAPAN

**UK Importer:**

JVCKENWOOD U.K. Limited  
First Floor, Gleneagles, the Belfry, Colonial Way,  
Watford, Hertfordshire WD24 4WH, UNITED  
KINGDOM

Hereby, JVCKENWOOD declares that the radio equipment "DMX80AXS" is in compliance with the relevant statutory requirements.

The full text of the declaration of conformity is available at the following internet address:

<https://www.kenwood.com/euukdoc/>

## Important Notice on Software

### Software License on This Product

The software embedded in this product comprises a number of independent software components, each of which is copyrighted by JVCKENWOOD Corporation or by a third party.

This product uses software components that are based on an End-User License Agreement (hereinafter called "EULA") stipulated by JVCKENWOOD Corporation and by third parties.

The EULA dictates the availability of the source codes of free-software components as a prerequisite to distributing them in executable form under the terms of the GNU General Public License or the Lesser General Public License (hereinafter called "GPL/LGPL"). To get information about the software components that are subject to the terms of the GPL/LGPL, please visit the following Website:

Website URL <https://www2.jvckenwood.com/gpl/>

Queries concerning the contents of the source code or the like will not be accepted.

Please note that software components based on a EULA that is not subject to the terms of the GPL/LGPL or those that have been developed or created by JVCKENWOOD Corporation will be excluded from the scope of source code disclosure.

Because licenses to use software components distributed under the GPL/LGPL are offered to the customers for free of charge, no warranty is granted to the customers, whether explicitly or implicitly, to the extent of the applicable laws.

Unless otherwise stipulated by the applicable laws or agreed upon in writing, the copyright holders or those who are entitled to modify and redistribute the software components are not held responsible for any and all damages resulting from their use or from inability to use them. For more information about the terms of use of the software components, required items of compliance and so on, please refer to the GPL/LGPL.

Customers wishing themselves to use a software component that is subject to the GPL/LGPL embedded in this product are encouraged to read the terms of the corresponding license before use. Because each individual license is prescribed by a third party other than JVCKENWOOD Corporation, the original (English) of the license is presented.

## EULA

### Software License Agreement

JVCKENWOOD Corporation (hereinafter called "Licensor") holds either the copyright to the embedded software or the right to sublicense it. This agreement establishes the conditions under which the customer uses this "Licensed Software."

The customer shall agree to the terms of this license agreement before proceeding to use Licensed Software.

This agreement is deemed to have taken effect when the customer (hereinafter called "User") has used a product implementation of Licensed Software.

The Licensed Software may contain software Licensor has been licensed to use by third parties directly or indirectly. Some third parties may have terms of use prescribed for their customers, apart from this Software License Agreement. This agreement does not apply to such software. Be sure to consult "Important Notice on Software" as presented separately.

#### Article 1 (General)

Licensor grants to User a non-exclusive, non-assignable right of use Licensed Software within the country where the User purchases the Product (hereinafter the "Country") (except for the exception provided for in Paragraph 1, Article 3).

#### Article 2 (Right of Use)

1. The rise of use granted under this agreement is the right to use Licensed Software in this product.
2. User may not duplicate, copy, modify, add to, translate or otherwise alter, or loan licensed Software and the associated literature in whole or in part.
3. Use of Licensed Software is limited to a private extent, and Licensed Software may not be distributed, licensed or sublicensed for any purposes whatsoever, including commercial use.
4. User shall use Licensed Software as per the instruction manual or instructions given in the help file and may not use or duplicate data in violations of the regulations of the Copyright Law or other governing laws by using Licensed Software in whole or in part.

### **Article 3 (Terms of License)**

1. In assigning this product, User may not retain the original copy of the embedded Licensed Software (including associated literature, updates and upgrades) and any duplicates and associated literature with regard to the license to use Licensed Software. User may transfer Licensed Software only to the condition of binding the assignee to abide by the terms of this Software License Agreement.
2. User may not reverse-engineer, disassemble, decompile or otherwise analyze the source code of Licensed Software.

### **Article 4 (Rights to Licensed Software)**

All rights to Licensed Software and the associated literature, including copyrights, shall reside with Licensor or the original right holder who has granted the Right of Use and right to sublicense to Licensor (hereinafter referred to as "Original Right Holder"), and User does not have any rights other than Right of Use granted hereunder with regard to Licensed Software and the associated literature.

### **Article 5 (Exemption Granted to Licensor)**

1. Licensor and Original Right Holder do not assume any responsibility for damages caused to User or third parties resulting from the exercise by User of the license granted hereunder, unless otherwise provided by any law to the contrary.
2. Licensor does not warrant Licensed Software to be merchantable, compatible and fit for specific purposes.

### **Article 6 (Responsibility for Third Parties)**

If disputes over the infringement of third parties' intellectual property rights, such as copyrights and patent rights, arise out of the use of Licensed Software by User, User shall resolve these disputes at User's own expenses while keep Licensor and Original Right Holder harmless.

### **Article 7 (Secrecy Obligation)**

User shall keep confidential Licensed Software provided hereunder, information contained in the associated literature or the like and those provisions of this agreement not yet in public knowledge and may not disclose or leak these to third parties without prior written consent from Licensor.

### **Article 8 (Cancellation of the Agreement)**

Licensor reserves the right to cancel this agreement forthwith and claim compensation from User for the damages caused by such cancellation when User:

- (1) Breaches any of the provisions of this agreement, or
- (2) Has received a petition for seizure, provisional seizure, provisional disposition or any other kind of compulsory execution.

### **Article 9 (Destruction of Licensed Software)**

If this agreement is terminated under the provision of the foregoing paragraph, User shall destroy Licensed Software, along with all associated literature and its duplicates, within two (2) weeks from the date of termination.

### **Article 10 (Copyright Protection)**

1. Copyrights and all other intellectual property rights relating to Licensed Software shall reside with Licensor and Original Right Holder and in no circumstances with User.
2. User shall abide by the laws relating to copyrights and intellectual property rights in using Licensed Software.

### **Article 11 (Export Control)**

1. Licensed Software and the associated literature or the like may not be exported to places outside the Country (including transmission outside the Country over the Internet or the like).
2. User agrees that Licensed Software is subject to export controls imposed by the Country and the United States of America.
3. User agrees to comply with all the international and domestic laws that apply to this software (U.S. Export Administration Regulations and regulations established by the U.S., the Country and their governmental agencies regarding usage by end users and export destinations).

### **Article 12 (Miscellaneous)**

1. Even if this agreement is invalidated in part by law, all other provisions shall remain in effect.
2. Licensor and User shall consult each other in good faith to resolve any matters not provided for in this agreement or questions arising from the interpretation of this agreement.
3. Licensor and User agree that this agreement is governed by the law of Japan and that all disputes involving claims and obligations that may arise out of this agreement will be settled by arbitration at the Tokyo District Court as the court of first instance.

---

**KENWOOD**